

T.25 & 26S. R.14E. W.M.

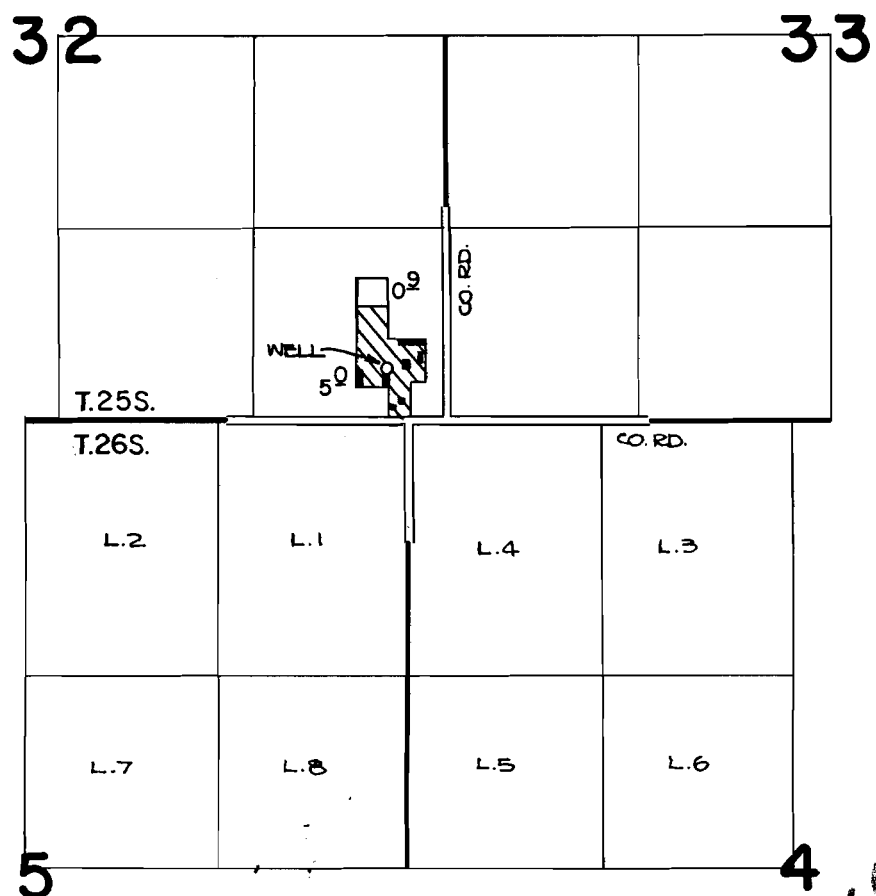

THE WELL IS LOCATED 310 FT. N. AND 400 FT. W. FROM THE S.E. CORNER OF SECTION 32.

Handwritten: 6587
 N
 A

FINAL PROOF SURVEY UNDER

SCALE: 4"=1 MILE

Application No. G-11158. Permit No. G-10327....
IN NAME OF

NORTH LAKE SCHOOL DISTRICT 14

Surveyed OCT. 14, 1984., by P. P. [Signature]