

URBAN GROWTH BOUNDARY
AND
WELL LOCATION.

MAP

FOR
WATER RESOURCES DEPT.

APPL. # G-10545

DESCHUTES

NATIONAL

FOREST

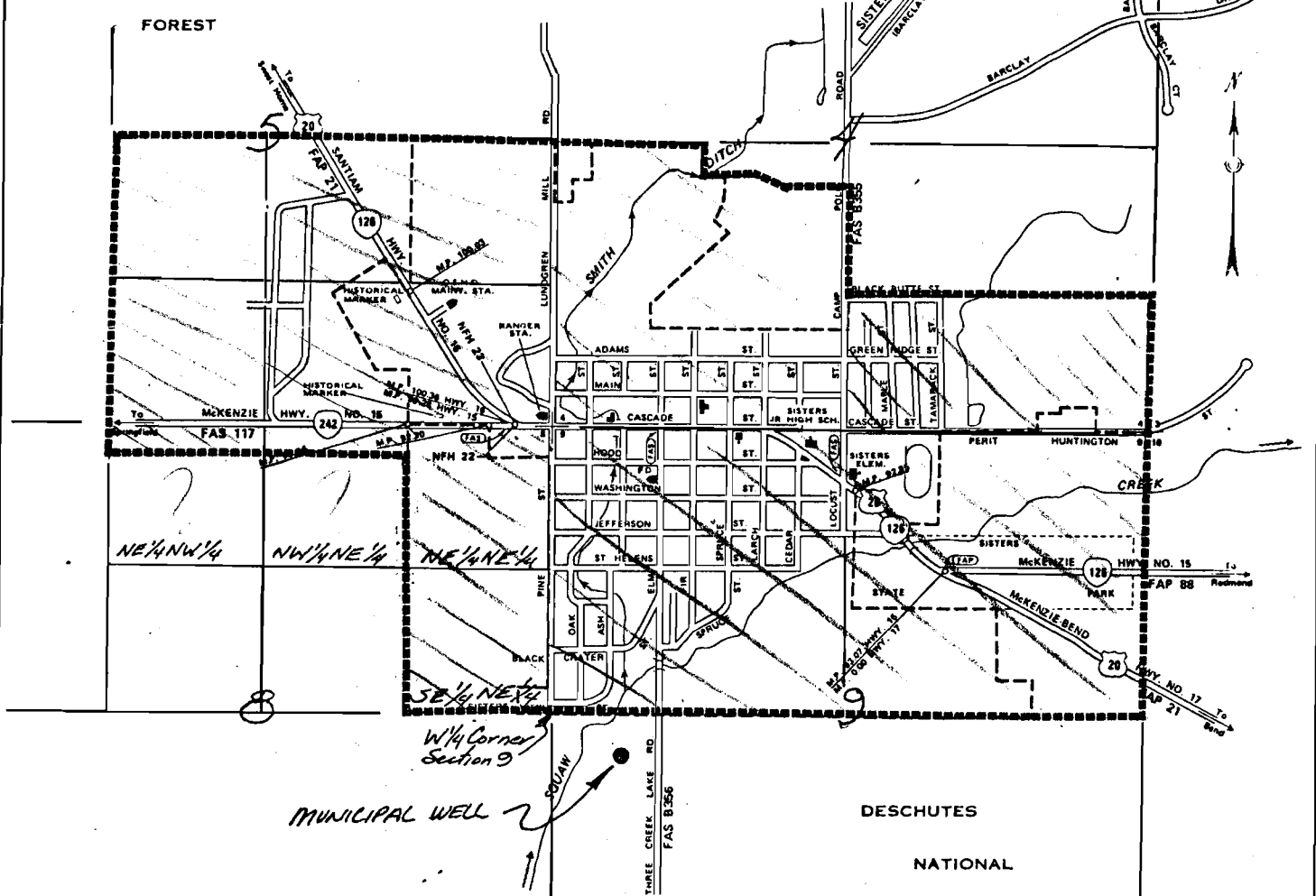

Well Located: 481.87 feet South and 706.96 feet East
from the West 1/4 corner Section 9
T 15 S R 10 E W.M.

RECEIVED

FEB 24 1983

WATER RESOURCES DEPT.
SALEM, OREGON

RECEIVED

JAN 28 1983

WATER RESOURCES DEPT.
SALEM, OREGON

----- URBAN GROWTH BOUNDARY

● EXISTING MUNICIPAL WELL

LEGEND

- ⬮ INTERSTATE NUMBERED ROUTE
- ⬮ U.S. NUMBERED ROUTE
- ⬮ STATE NUMBERED ROUTE
- ⬮ TERMINATION OF FA SYSTEM
- ⬮ DIVIDED HIGHWAY
- ⬮ STREET OPEN FOR TRAVEL
- ⬮ POST OFFICE
- ⬮ SCHOOL
- ⬮ CITY CENTER
- ⬮ CITY LIMITS
- ⬮ PUBLIC AREA
- ⬮ PUBLIC BUILDING
- ⬮ COURT HOUSE
- ⬮ CITY HALL
- ⬮ ARMORY
- ⬮ LIBRARY

SISTERS
DESCHUTES COUNTY, OREGON

PREPARED BY THE
OREGON STATE HIGHWAY DIVISION
IN COOPERATION WITH
U.S. DEPARTMENT OF TRANSPORTATION
FEDERAL HIGHWAY ADMINISTRATION

Population 790
Revised July 1980

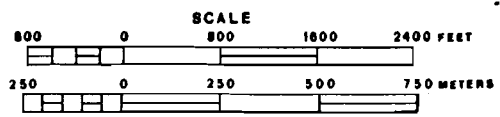

Copies of the map are available at nominal cost from Oregon Dept. of Transportation, Salem, Oregon 97310.

Application No. G-10545

Permit No. G 9979

REVISED MAP BY JOHN RANKIN
1-26-83

CERT. # 66520

INSPECTION: M.F.P. MAP

G-9979