

T. 30S., R. 3W., W.M.

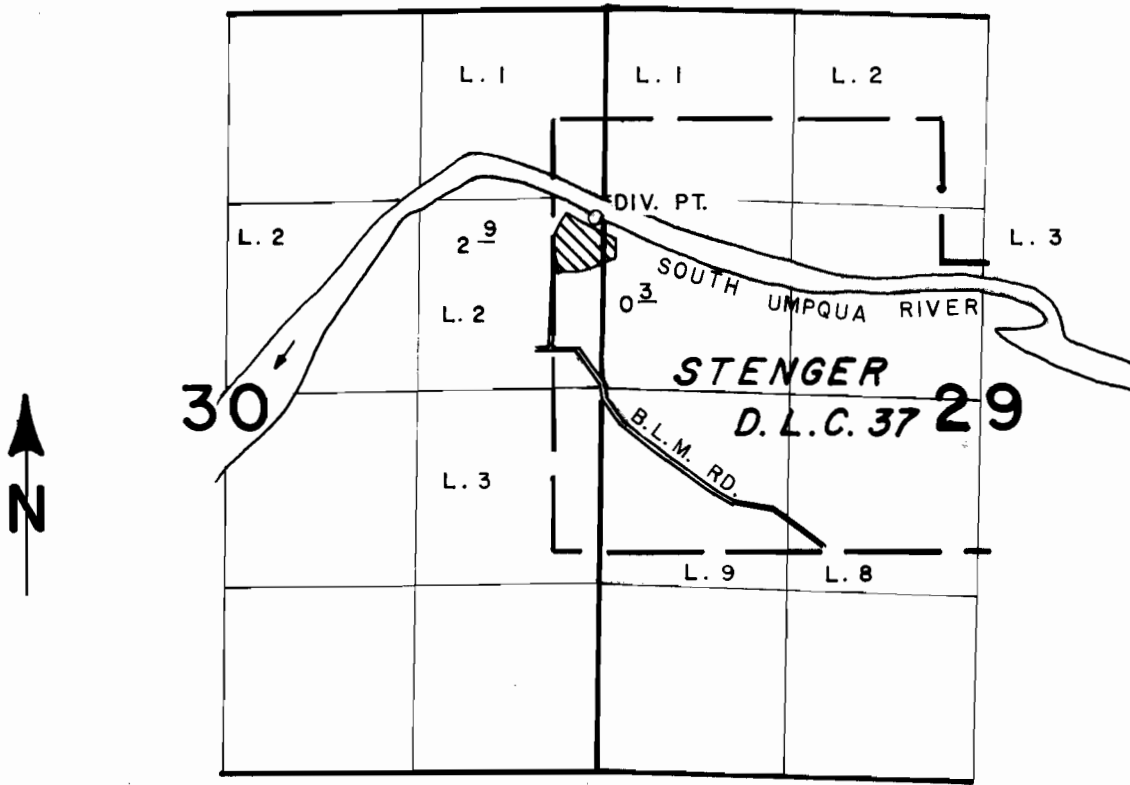

DIV. PT. LOCATED 1160' N. & 50' W. FROM E. 1/4 CORNER SEC. 30.

SCALE: 4" = 1 MILE

FINAL PROOF SURVEY UNDER

Application No. 65520. Permit No. 47776.....
IN NAME OF

ROBERT D. CONLEY.....

Surveyed JULY 28 1987, by J. M. SCHMORDE