

# T.3S., R.5W., W. M.

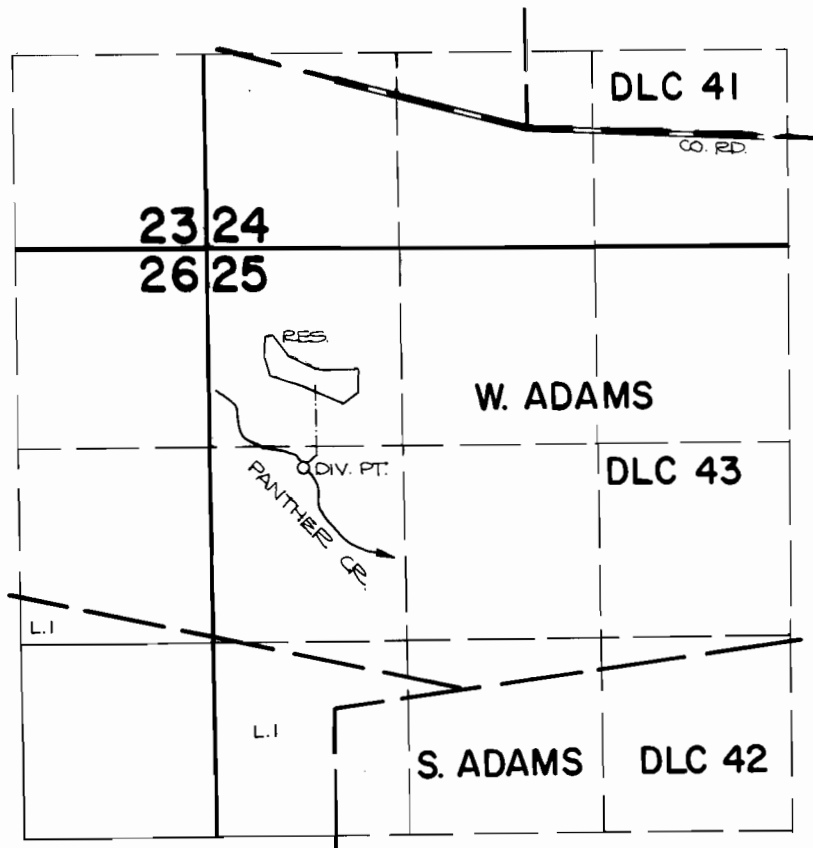

DIV. PT. LOCATION: 1500 FT. S. AND 650 FT. E. FROM THE N.W. CORNER OF SECTION 25.

## FINAL PROOF SURVEY UNDER

N

SCALE: 4" = 1 MILE

Application No. 66603... Permit No. 48087.....  
IN NAME OF

.....VICTOR THUMBERG.....

Surveyed JULY 11, 1984., by *P. Pagter*.....