

T. 6N., R. 34E., W. M.

21-66042

66553

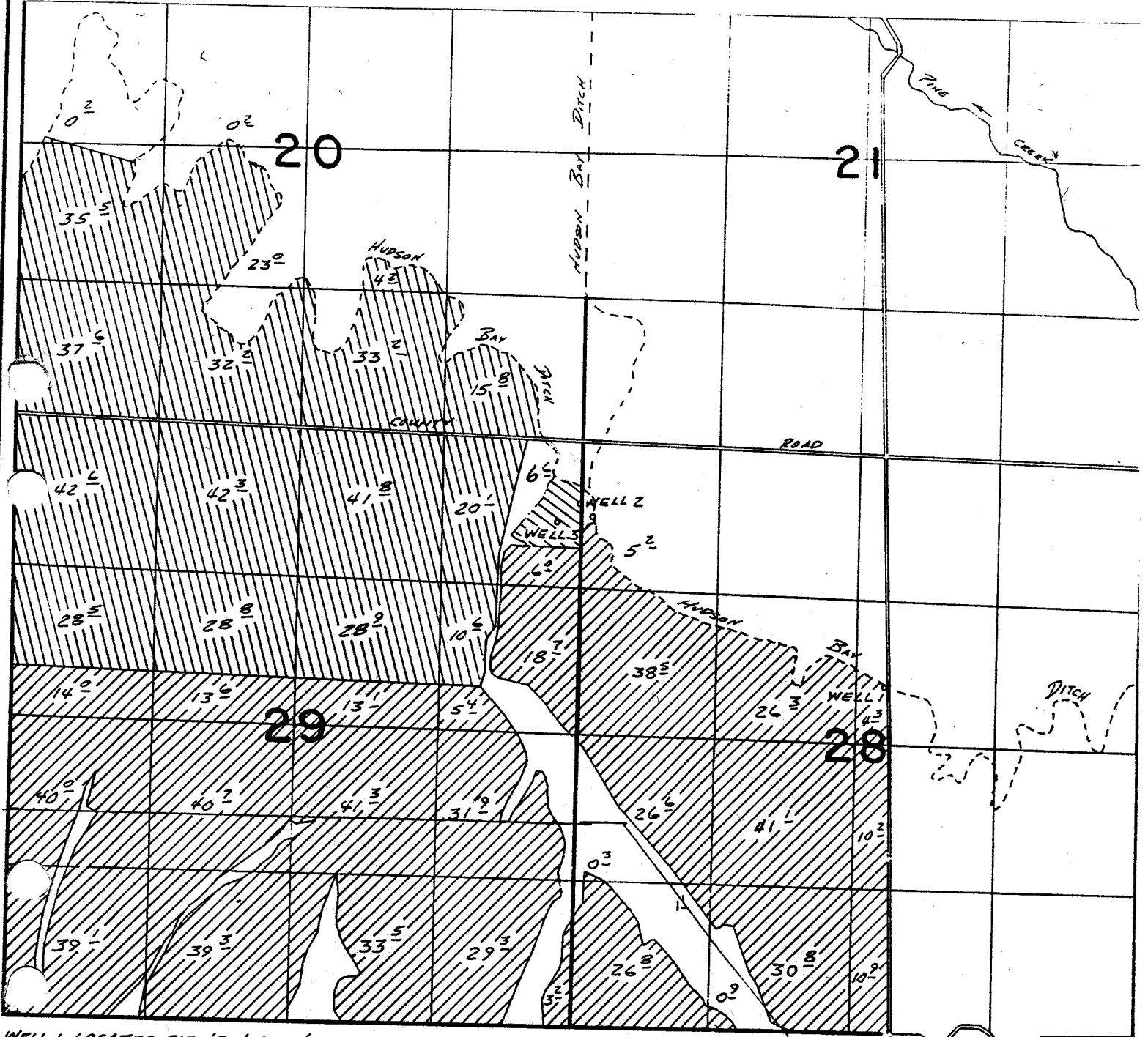

WELL 1 LOCATED 2130'S. & 2930'E. FROM NW COR SEC. 28
 WELL 2 LOCATED 570'S. & 10'W. FROM NE COR SEC 29
 WELL 3 LOCATED 740'S. & 230'W. FROM NE COR SEC 29

FINAL PROOF SURVEY

UNDER

APPL. G-7223 PER. G-6642

IN NAME OF

JOHN P. & JEAN H. WEIDERT

SURVEYED MAY 5, 1978 BY R. BARWIN

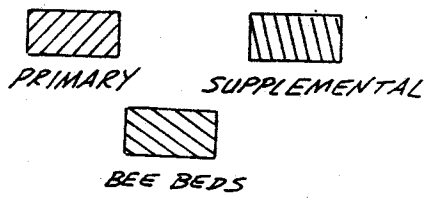

SCALE: 1" = 1320'

2512
 FL 210-19, 21
 REV. 10-22-85 VLL