

Application No. 54897
Permit No. 41184

T.9S.R.26E.W.M.

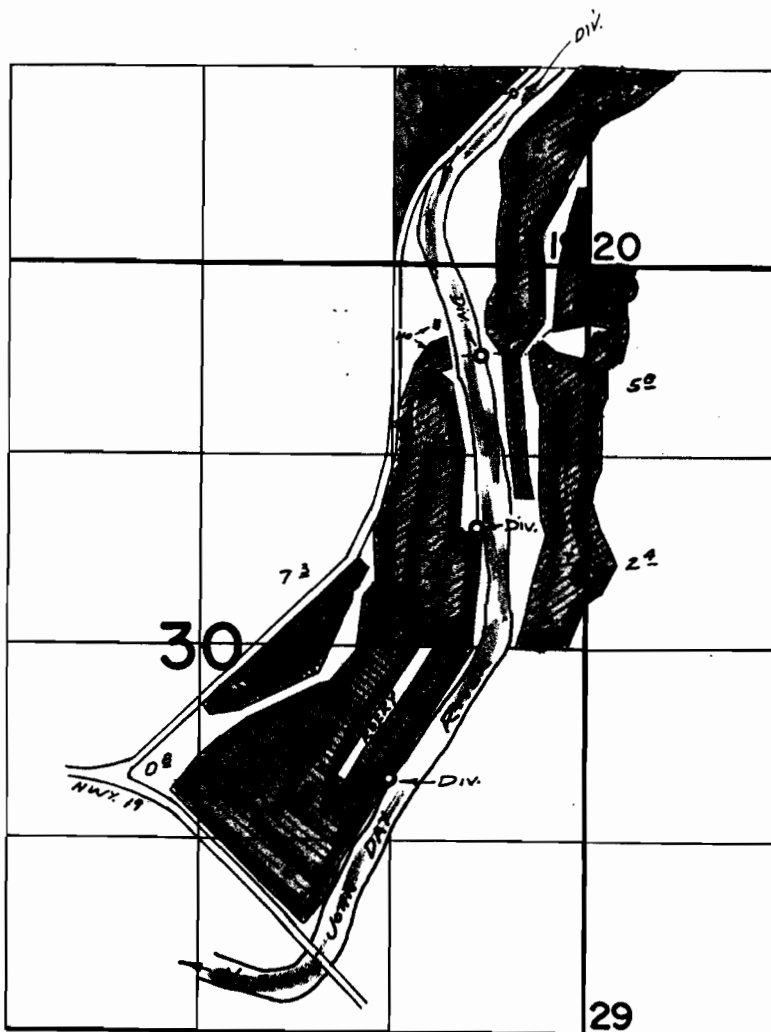

APPL. 38224 APPL. 43440 APPL. 49123 (not surveyed 12/9/76) *See*
DIV. PTS. LOC: 620'S & 730'W; 1800'S & 750'W; 3510'S & 1330'W, 1170'N & 510'S
ALL FROM N.E. COR. SEC. 30

for frost protection
FINAL PROOF SURVEY
UNDER

Application No. ~~43440~~ ³⁸²²⁴ Permit No. ~~32495~~ ²⁸⁴⁸⁰
IN NAME OF

.....THOMAS ORCHARDS, INC.....

Surveyed ~~July 17, 1971~~ 1971., by ~~R. MUGKEN~~