

T. 36 S., R. 11 E., W.M.

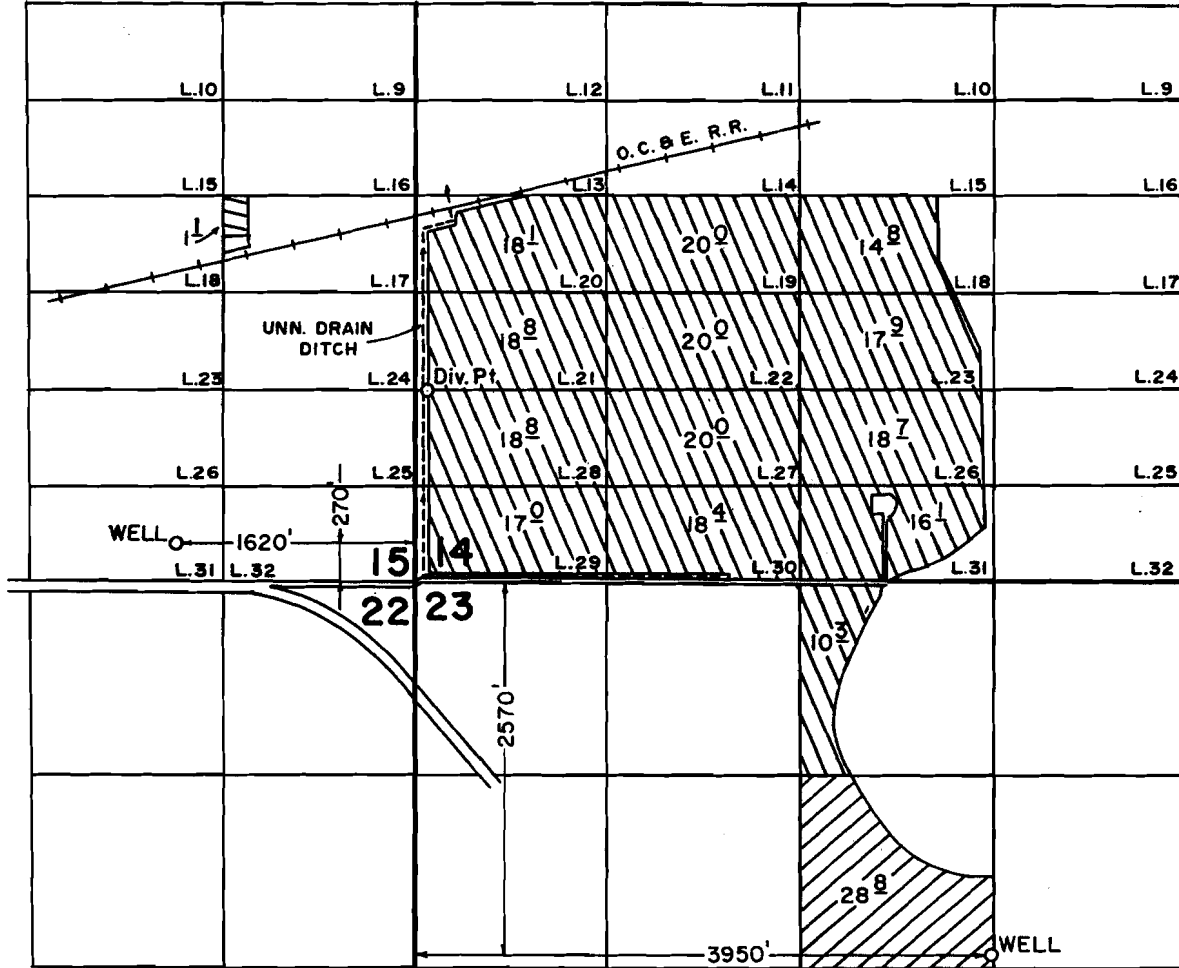

DIV. PT. LOC.: 1310' N. & 80' E. FROM THE SW CORNER OF SECTION 14.

SCALE: 1" = 1320'

FINAL PROOF SURVEY

UNDER

63732

G-9409

Application No. G-8182. Permit No. G-7651.....

IN NAME OF

EDWIN K. & BONNIE B. VIEIRA

Surveyed SEPT. 27, 1989, by B.W. BISHOP.....



Supplemental

Primary

Primary

Sprague River Misc.