

T.12S. R6W. W.M.

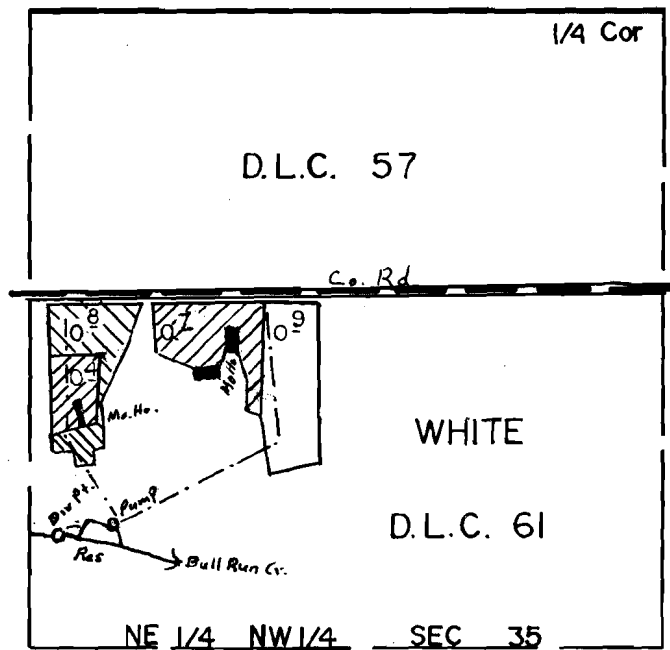

Div. Pt. Loc. 1080'S. & 1240'W., Res. Loc. 1050'S. & 1150'W.
Both From The N 1/4 Of Section 35

SCALE: 1" = 400'

FINAL PROOF SURVEY
UNDER

R-63619 R-8514
Application No. **63620** Permit No. **47081**.....
IN NAME OF

.....**KENNETH M. ROWLAND**.....

Surveyed **MAY 1**..... 1987., by **I.M. WARREN**.....

