

T.12S. R6W. W.M.

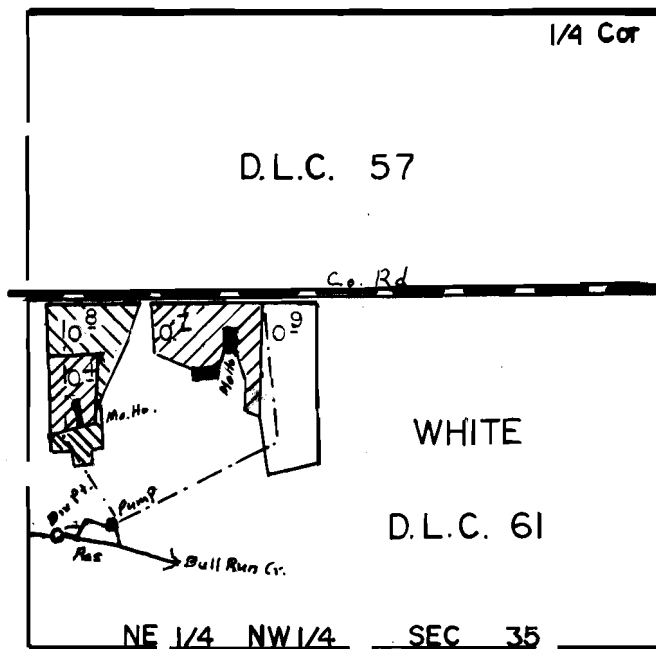

Div. Pt. Loc. 1080'S. & 1240' W., Res. Loc. 1050'S. & 1150' W.
 Both From The N 1/4 Of Section 35

SCALE: 1" = 400'

FINAL PROOF SURVEY UNDER

R-63619 R-8514
 Application No. 63620 Permit No. 47081.....
 IN NAME OF

.....KENNETH M. ROWLAND.....

Surveyed MAY..1..... 1987.., by I.M. WARREN.....

