

FEB 18 1991

WATER RESOURCES DEPT.
SALEM, OREGON

N.E. COR S.7

N. 1/4 S.7

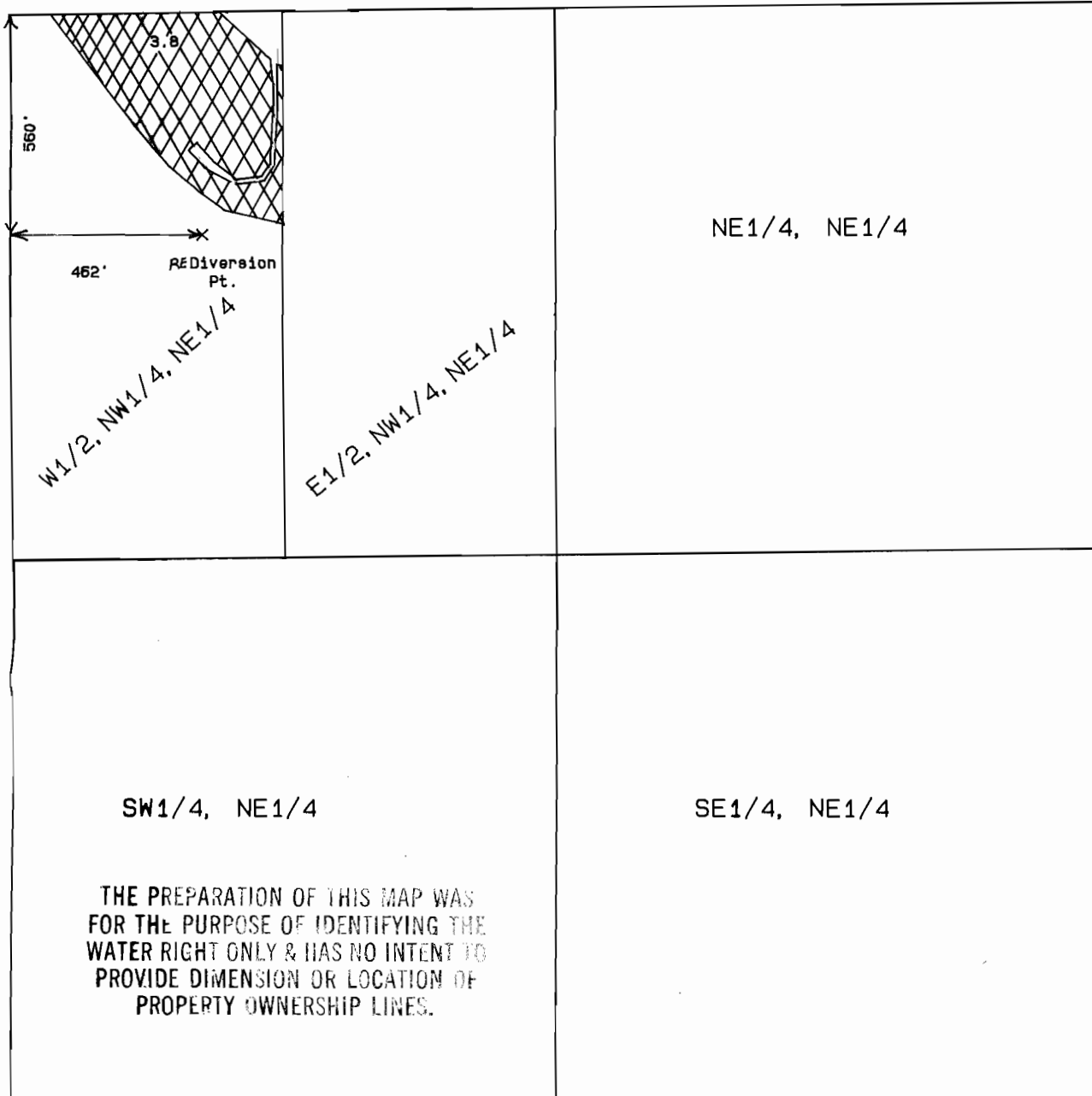

SW1/4, NE1/4

SE1/4, NE1/4

THE PREPARATION OF THIS MAP WAS
FOR THE PURPOSE OF IDENTIFYING THE
WATER RIGHT ONLY & HAS NO INTENT TO
PROVIDE DIMENSION OR LOCATION OF
PROPERTY OWNERSHIP LINES.

C.1/4, S.7

E.1/4 S.7

REVISED
FINAL PROOF MAP
under

Application No. 69548 Permit No. 50627
In Name Of

JOSEPH E., AND PAMELA A. GOUVEIA

Mapped Dec. 14, 1990 Scale: 1"=400'

Mapped By: L.J. Friar & Associates P.C.
Consulting Land Surveyors
304 South Holly Street
Medford, OR 97501
(503) 772-2782

