

FINAL PROOF SURVEY

T.36S., R.14W., W.M.

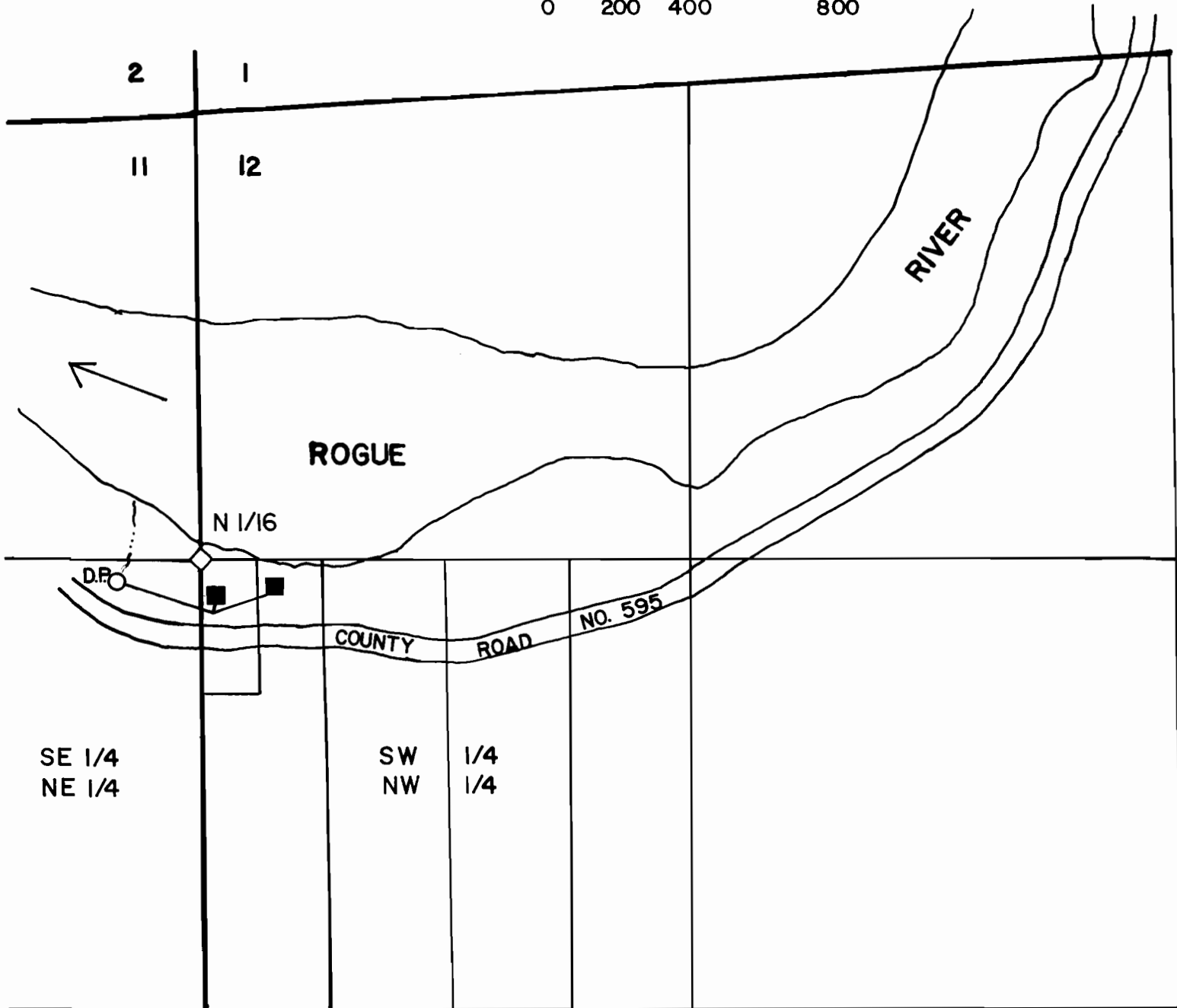
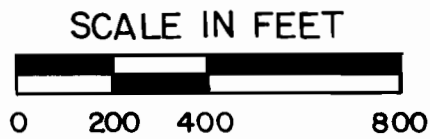

DIVERSION POINT IS 50.1' SOUTH & 232.0' WEST OF THE BRASS CAP FOR THE N 1/16 OF SEC. 11 & 12.

APPLICATION NO. 70147 PERMIT NO. 51162

IN THE NAME OF RAYMOND E. & ROSE MARIE PIRKL

SURVEYED 10/89 BY THOMAS J. HOWIE, WRE 070.

THIS MAP SHOWS THE LOCATION OF A WATER RIGHT ONLY AND HAS NO INTENT TO PROVIDE DIMENSIONS OR LOCATION OF PROPERTY OWNERSHIP LINES.

