

T. 26 S., R. 7 W., W. M.

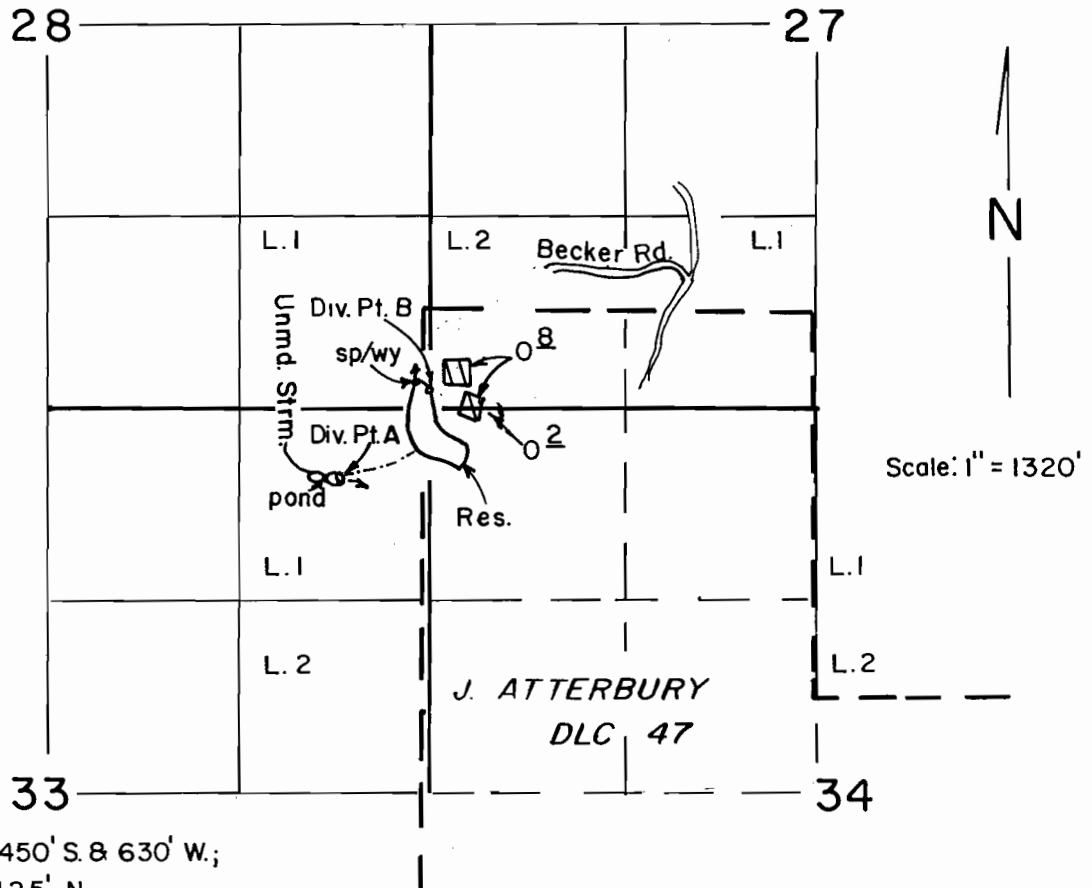

Div. Pt. A - 450' S. & 630' W.;
 Div. Pt. B - 125' N.;
 Both from SW cor. Sec. 27

FINAL PROOF SURVEY
 UNDER

R-68292 R-10481
 Application No. 68245... Permit No. 49355.....
 IN NAME OF

.....FRED.....E.....THORBURN.....

Surveyed JUN. 14. 1988, by J. M. SCHMORDE
 AUG. 16 1990, by B. S. JAMES