

T. 18S., R. 44 & 45 E., WM

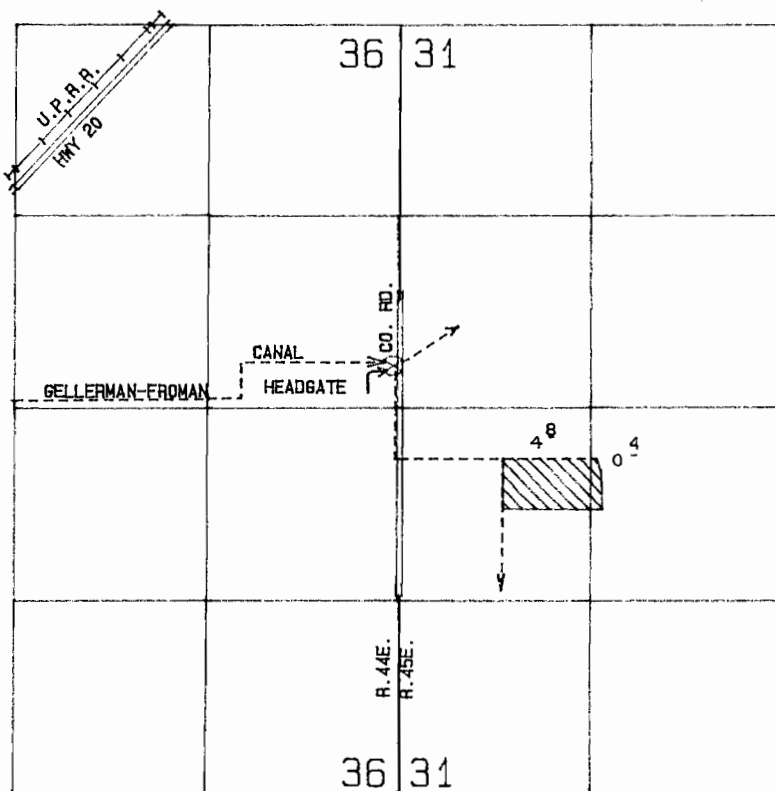

DIVERSION LOCATED: 390 FT. S. & 230 FT. E. FROM THE
CENTER 1/4 CORNER OF SECTION 8 T.19S., R.45E., W.M.
SCALE 1 IN = 1320 FT

FINAL PROOF SURVEY
UNDER

APPLICATION NO.: 65224 PERMIT NO.: 47659
IN THE NAME OF
WARMSPRINGS IRRIGATION DISTRICT

SURVEYED APRIL 28, 1986 BY: L. M. TOLL

COMPUTER DRAFTED: BWB
P.T.S. 1986-V-A