

TR. 1 N. R. 10 W. W. M.

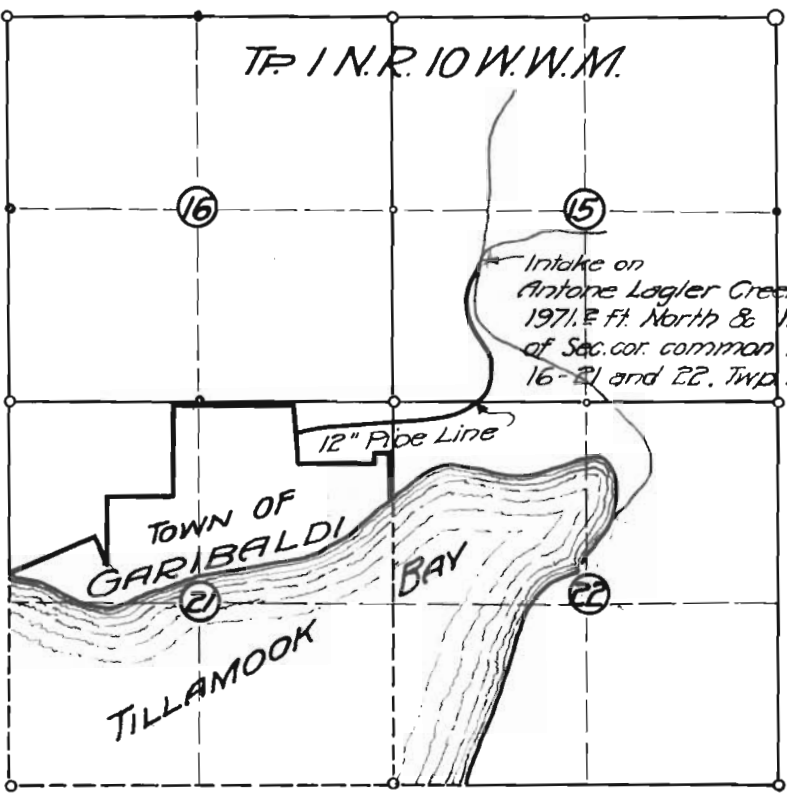

Intake on
 Antone Lagler Creek which is
 1971.2 ft. North & 1196.2 ft. East
 of Sec. cor. common to Secs. 15-
 16-21 and 22, Twp. 1 N. R. 10 W. W. M.

TOWN OF
 GARIBALDI

TILLAMOOK

BAY

12" Pipe Line

STATE ENGINEER
 RECEIVED

MAY 13 1924

SALEM, OREGON

Application No. 9513
 Permit No. 6309



MAP OF SURVEY OF
 WATER RIGHT
 on Antone Lagler Creek
 to be acquired by THE
 WHITNEY COMPANY for
 distribution in Town of Garibaldi.

GARIBALDI, TILLAMOOK CO. ORE.

Scale: 2" = 1 Mile

Surveyed 4-22-24.