

T.7S., R.2W., W.M.

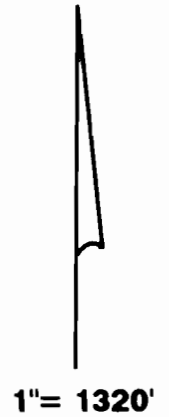
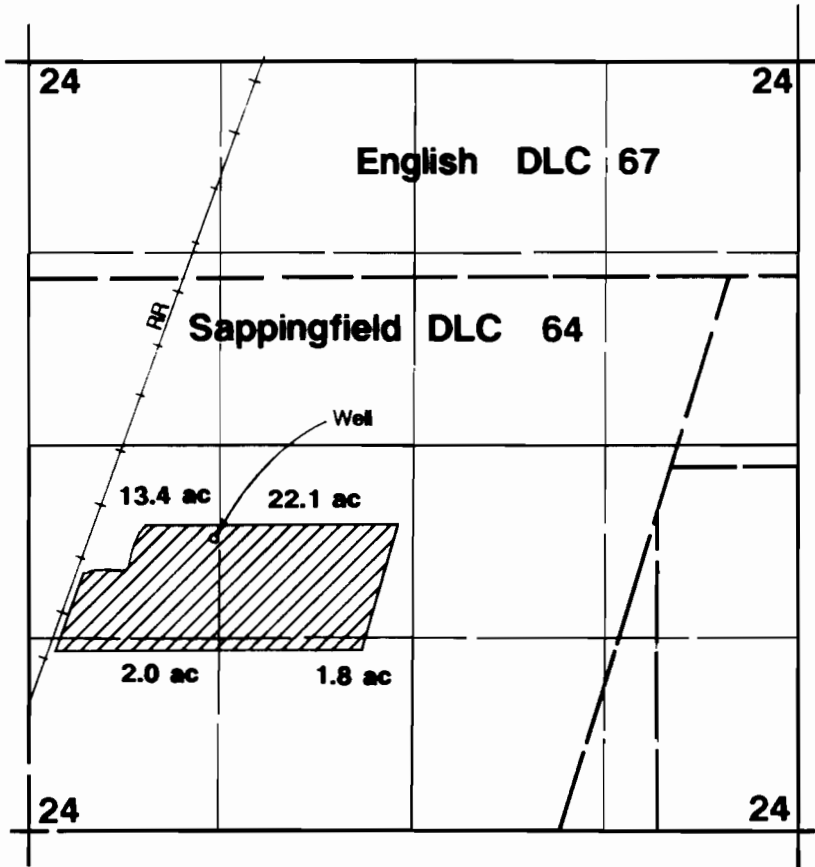

Area Irrigated

Well located 1980'N & 1305'E from SW corner Section 24.

Final Proof Survey



Application #G-11797 Permit #G-10916

In Name Of

Raymond J. Satter

Surveyed on June 30, 1990 by JM Schuette

NOTE: Map is for purpose of identifying location of water right and has no intent to dimension or locate property ownership lines.