

T.30S. R.5<sup>1</sup>/<sub>2</sub>6W. W.M.

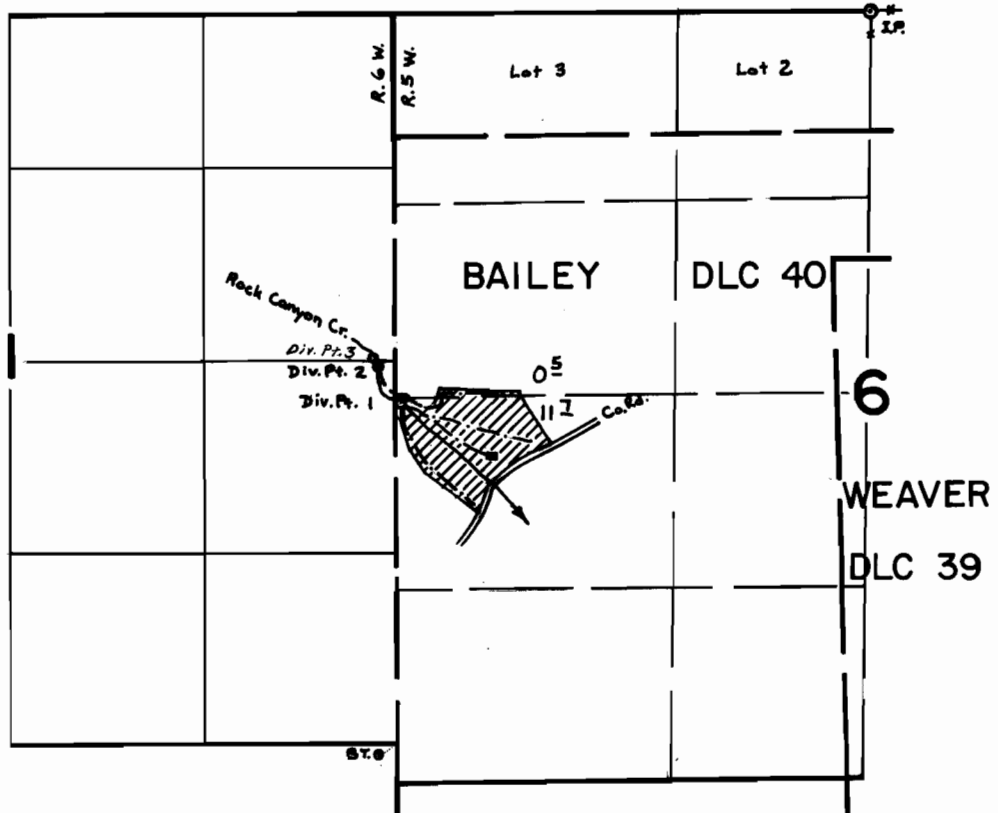

Div. Pts. Located: 1- 10'S & 30'E from the W<sup>1</sup>/<sub>4</sub> Cor. Sec. 6, T.30S. R.5W.  
 2- 30'S & 120'W from the E<sup>1</sup>/<sub>4</sub> Cor. Sec. 1, T.30S. R.6W.  
 3- 20'N & 130'W from the E<sup>1</sup>/<sub>4</sub> Cor. Sec. 1, T.30S. R.6W

**FINAL PROOF SURVEY**  
 UNDER

Application No. 45657 Permit No. 34048  
 IN NAME OF  
VERA M. WHITE

Surveyed March 13 1979, by S. Donaldson