

T.10S., R.4W., W.M.

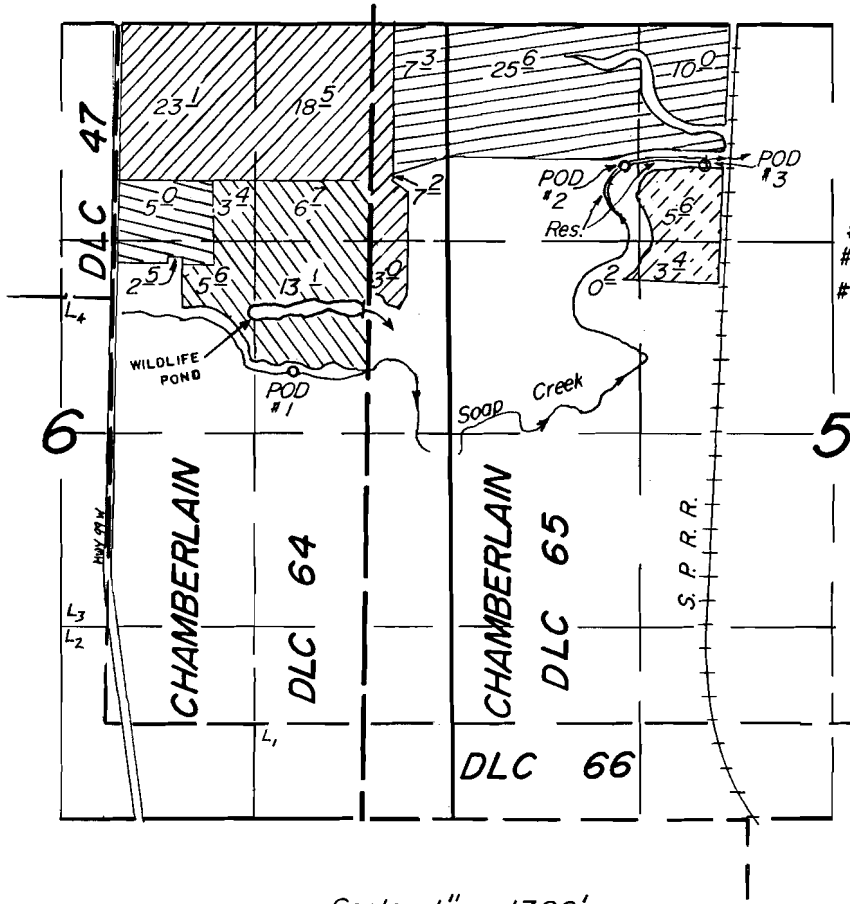
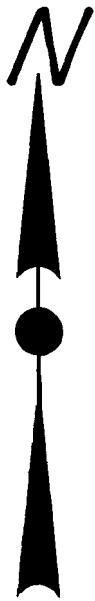

POD Locations:
 #1: 420' N., 1050' W.
 #2: 1840' N., 1220' E.
 #3: 1840' N., 1760' E.
 All from E. 1/4 Cor.
 Sec. 6.
 T.10S., R.4W., W.M.

Scale: 1" = 1320'

FINAL PROOF SURVEY

UNDER



R-57851
 57852
 59831

R-7823
 44137
 44956

Application No. 61441 Permit No. 45738

IN NAME OF

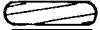
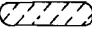
GEORGE W. GORDON

 POD #1  POD #3
 Primary
 Supplemental

Surveyed Sept. 6 1984, by Pete Pagter