

T.10S., R.4W., W.M.

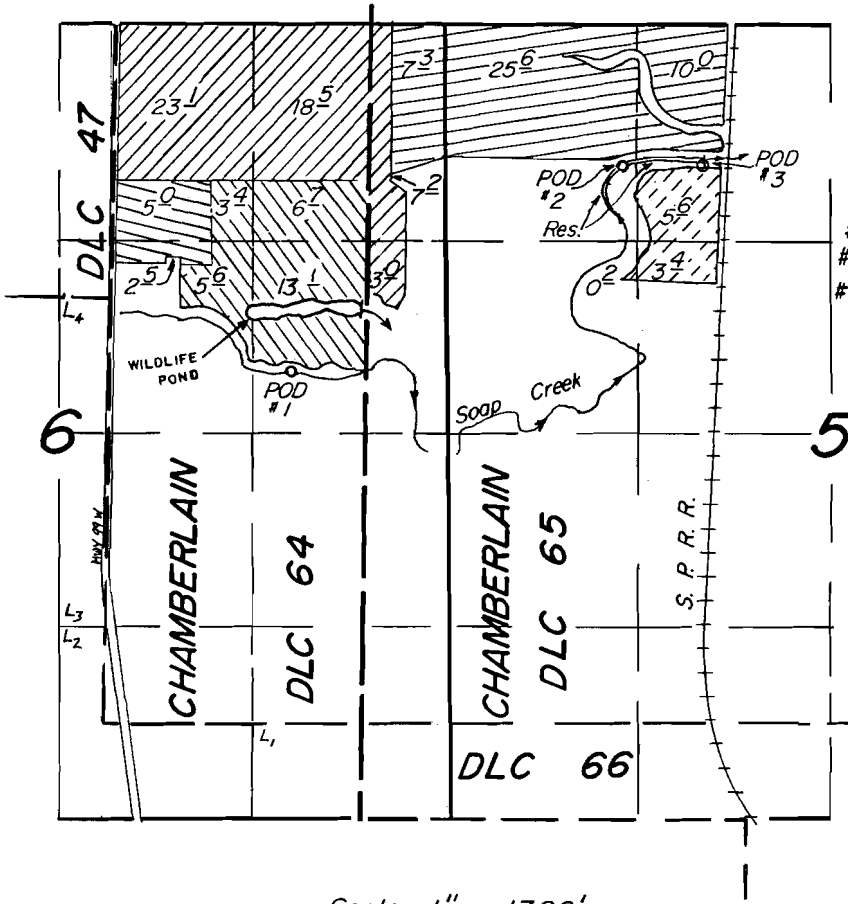
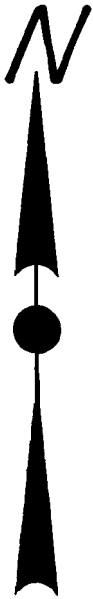

POD Locations:  
 #1: 420' N., 1050' W.  
 #2: 1840' N., 1220' E.  
 #3: 1840' N., 1760' E.  
 All from E. 1/4 Cor.  
 Sec. 6.  
 T.10S., R.4W., W.M.

Scale: 1" = 1320'

**FINAL PROOF SURVEY**

UNDER





R-57851  
 57852  
 59831

R-7823  
 44137  
 44956

Application No. 61441..... Permit No. 45738.....

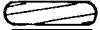
IN NAME OF

GEORGE W. GORDON

 POD #1  POD #3  
 Primary  
 Supplemental

Surveyed Sept. 6... 1984.. by Pete Pagter.....