

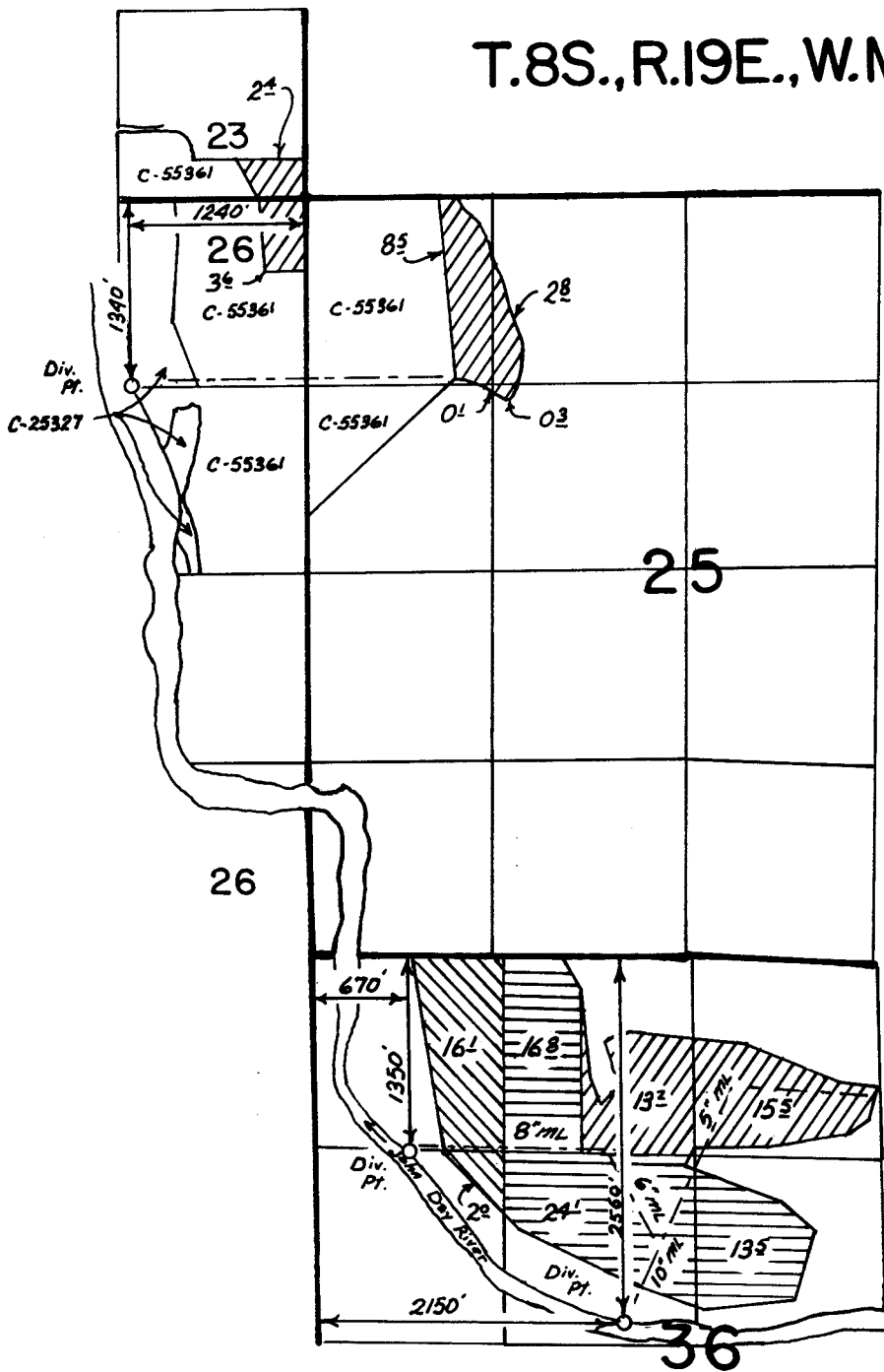



P-44743

67089
67108
67096

T.8S., R.19E., W.M.



-  P# 49236
-  P# 47461
-  P# 44743



Scale: 1" = 1320'

FINAL PROOF SURVEY

UNDER

59731	44743
64970	47461

Application No. 68246 Permit No. 49236

IN NAME OF
 OREGON DEPARTMENT OF TRANSPORTATION
 BILLY M. CROSS

Surveyed 1-31 1991, by K. Kemp