

# T.7S & 8S., R.2W., W.M.

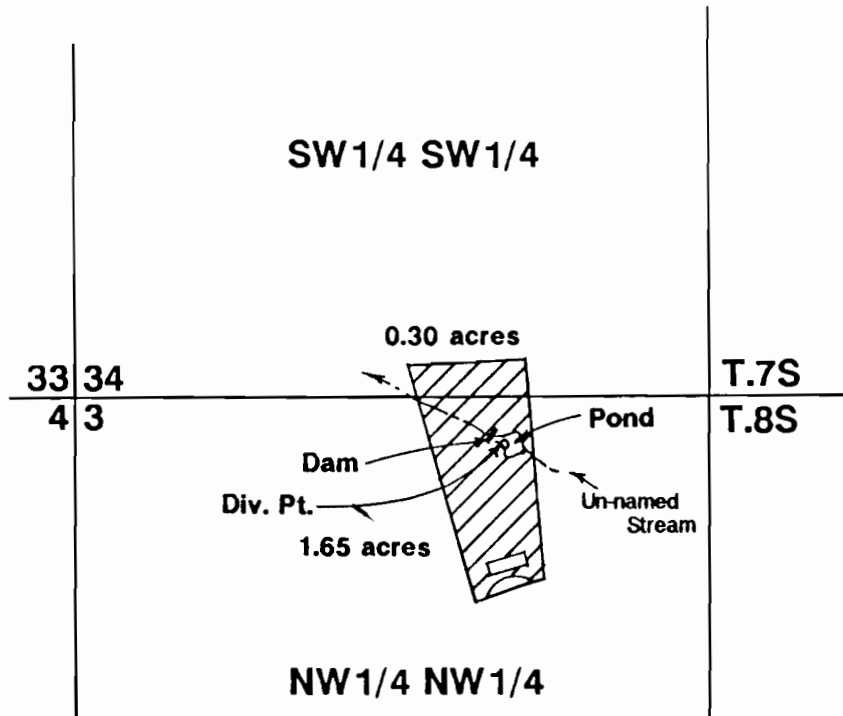

Dam located 80'S & 870'E from NW corner Section 3.  
Div. Pt. located 100'S & 900'E from NW corner Section 3.

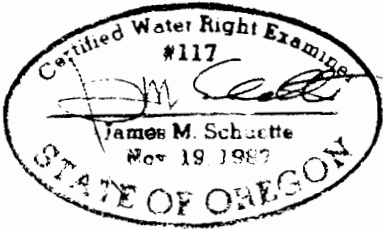

## Final Proof Survey

Application #: 69793

R-69792

In Name Of

Permit #: 50972

R-11226

Larry Lincoln

Surveyed on October 19, 1990 by JM Schuette

NOTE: Map is for purpose of identifying location of water right and has no intent to dimension or locate property ownership lines.