

T.1S., R.13E., W.M.

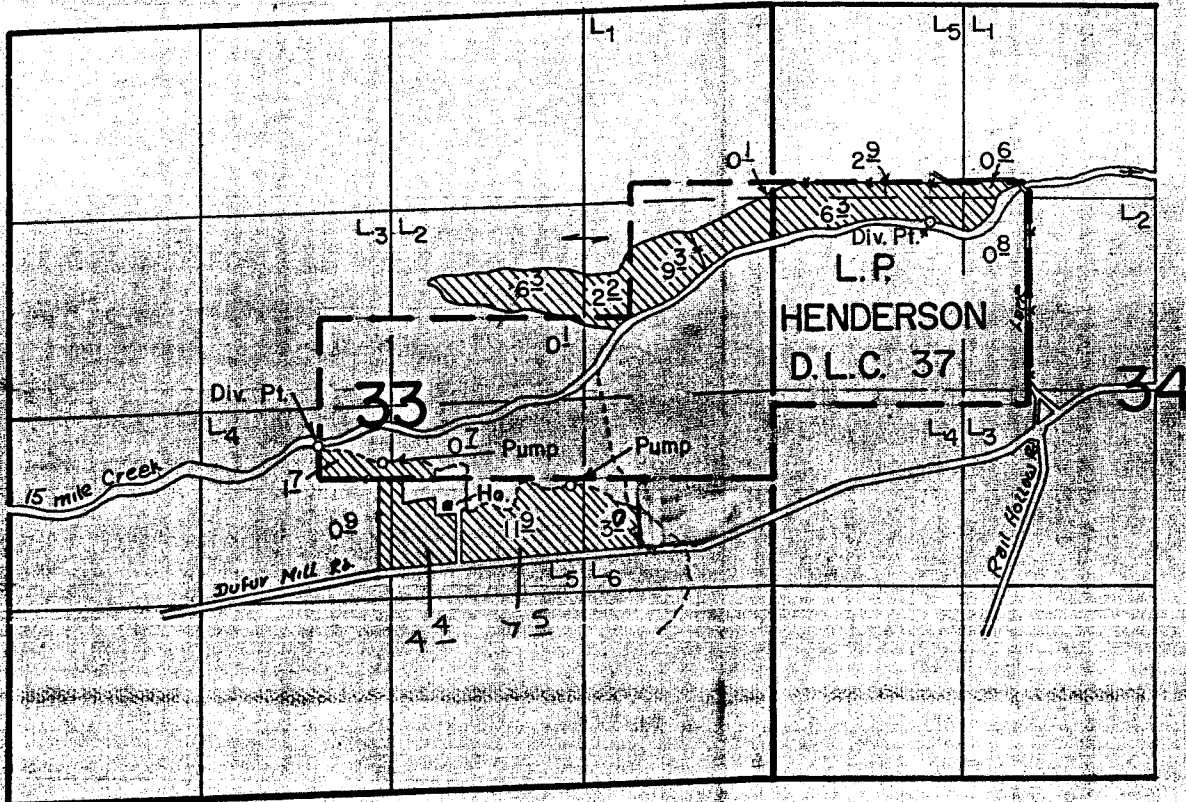

Div. Pts. Loc. 220 N. from the SW Cor Henderson D.L.C. 37; 260'S + 690'W. From the N.E. Cor Henderson D.L.C. 37

- See Transfer 6277

FINAL PROOF SURVEY
UNDER

Application No. 55939..... Permit No. 44313.....
IN NAME OF

..... GENE UNDERHILL

Surveyed June 29 1982, by T. J. Paul.....

Revised 1-14-10 138
Photo 41065-179-