

# T. 11 S., R. 2 W., W.M.

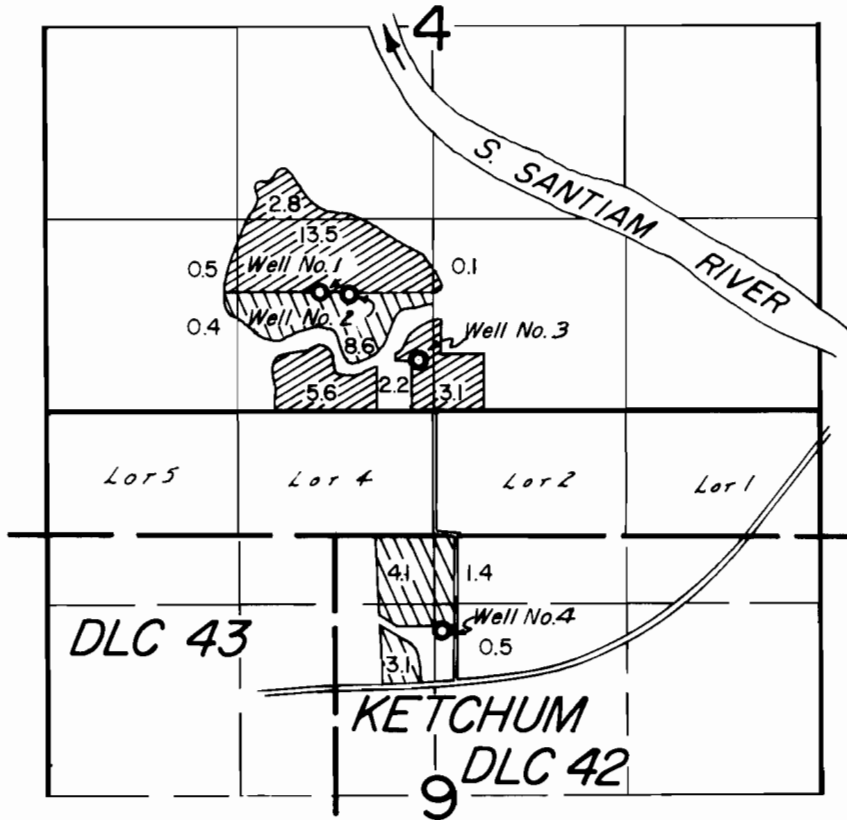

Wells Loc.: No. 1 - 820 A.N. & 780 A.W.; No. 2 - 810 A.N. & 570 A.W.;  
 No. 3 - 350 A.N. & 100 A.W.; No. 4 - 1510 A.S. & 50 A.E.;  
 all from the 1/4 Cor Common to Sections 4 & 9

## FINAL PROOF SURVEY UNDER

Application No. G-6180 Permit No. G-5857....

IN NAME OF

Hulan & Carol Miller

Surveyed MAY 4, 1979, by *[Signature]*