

T. 2N. R. 4W. W.M.

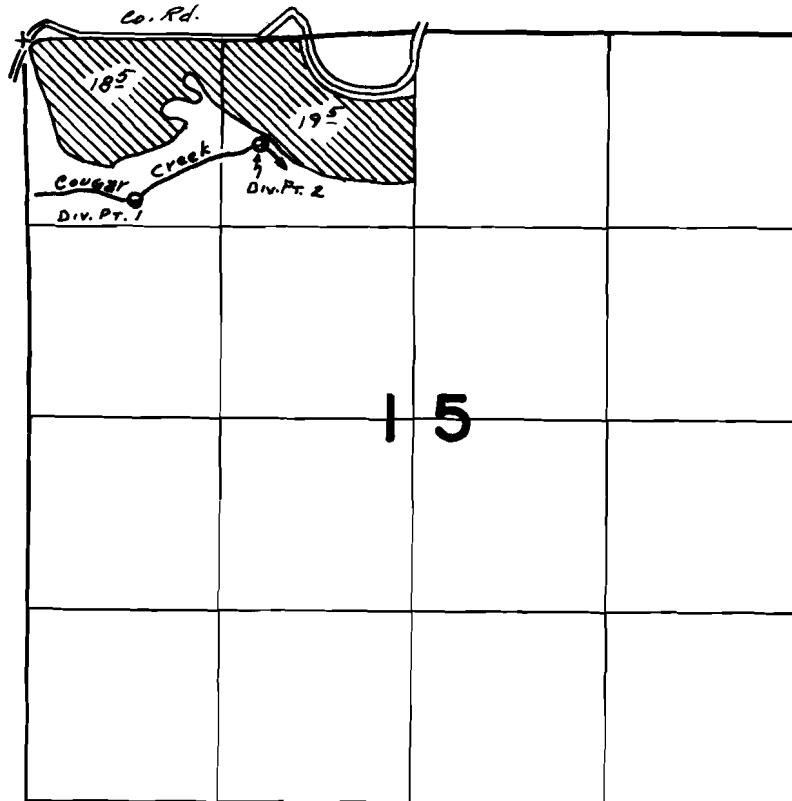

Div. Pt. #1 - 1150' S & 700' E
Div. Pt. #2 - 700' S & 1560' E Both from NW Cor. Sec. 15

FINAL PROOF SURVEY UNDER

Application No. 43826 Permit No. 32763
IN NAME OF

LESTER L. HOLLIS

Surveyed 11-4 1977, by J.S. Donaldson