

T.37S.,R.11 1/2E.,W.M.

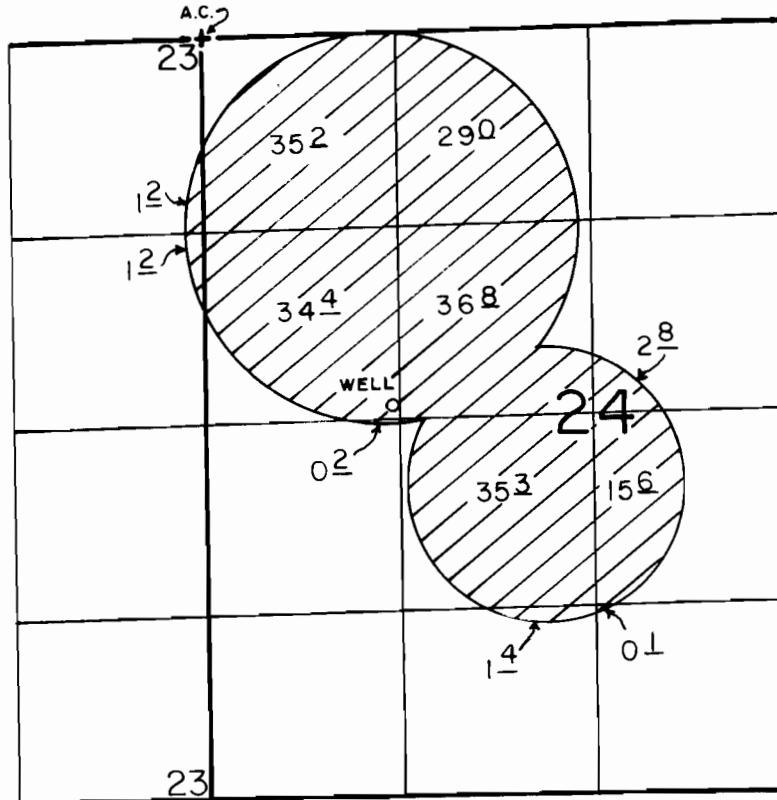

WELL LOC.: 2570'S. & 1280'E. FROM NW COR. OF SEC 24.

SCALE: 1" = 1320'

FINAL PROOF SURVEY
UNDER

Application No. G-11622 Permit No. G-10700..
IN NAME OF

JELD - WEN, INC.

Surveyed JUNE 12 1991., by B.W. BISHOP.