

T2S, R25E, W.M., MORROW CO., OR.

FINAL PROOF SURVEY

UNDER PERMIT 50253
Application 69580

IN THE NAME OF C.P. FARM, C.K. PECK, CLARKS CANYON ROAD
LEXINGTON, OR. 97839
PH. 989-8151



SCALE:
1" = 1320'

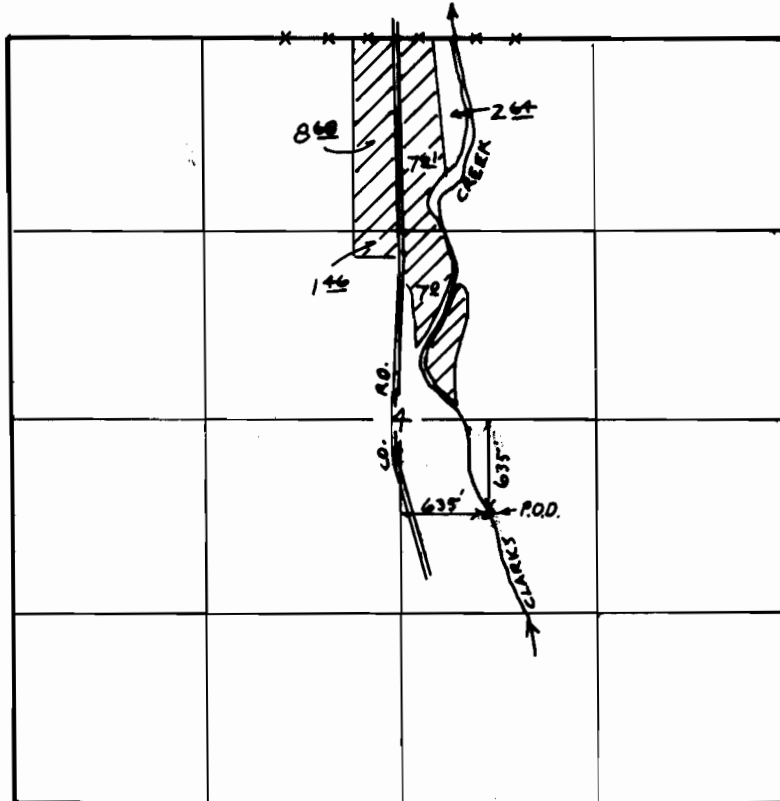

This map is for identifying the location of water rights only and is not intended to show property lines or dimensions.

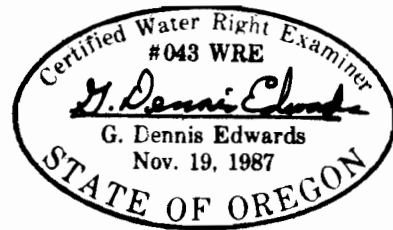

RECEIVED

APR 11 1991

WATER RESOURCES DEPT
SALEM, OREGON

EDWARDS SURVEYING P.O. BOX 763
567-3336 HERMISTON, OR 97838
2/22/91 W8805018