

RECEIVED

JUL 17 1991

WATER RESOURCES DEPT.
SALEM, OREGON

T.8S., R.6W., W.M.

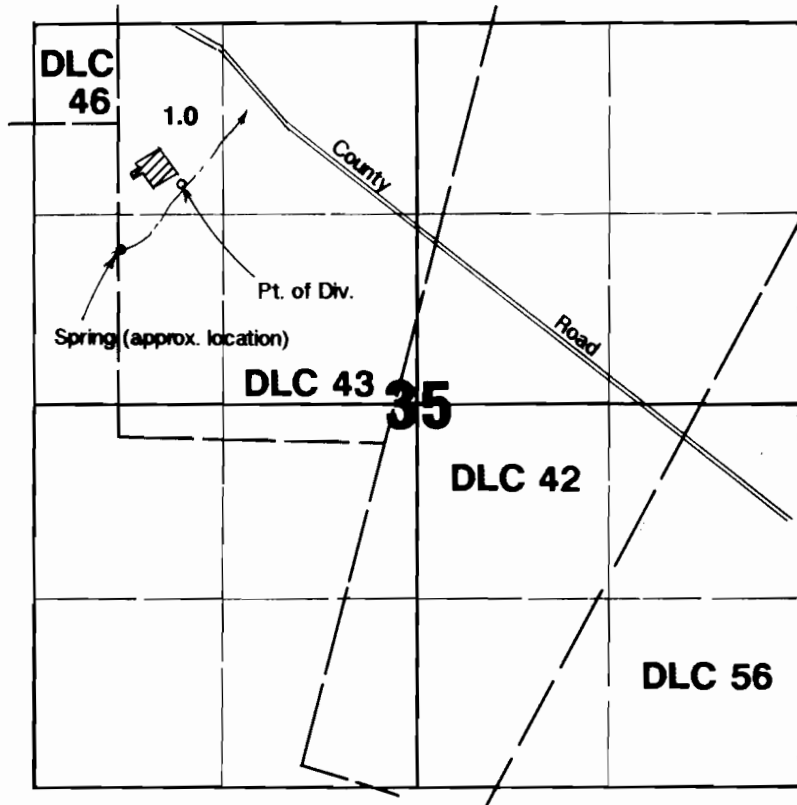

Pt. of Div. located 1100'S & 1000'E from NW corner Section 35.

Final Proof Survey

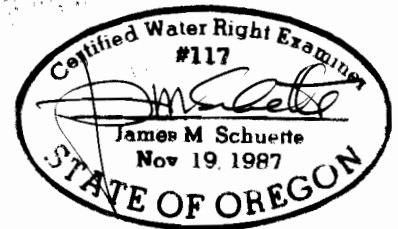

Application #70115 Permit #50983

In Name Of

Paul F. Kirk

Surveyed on July 1, 1991 by **JM Schuette**

THIS MAP WAS PREPARED FOR THE PURPOSE OF IDENTIFYING THE LOCATION OF A WATER RIGHT ONLY AND IS NOT INTENDED TO PROVIDE LEGAL DIMENSIONS OR LOCATION OF PROPERTY OWNERSHIP LINES.