

T. 7 & 8 S. R. 45 & 46 E. W.M.

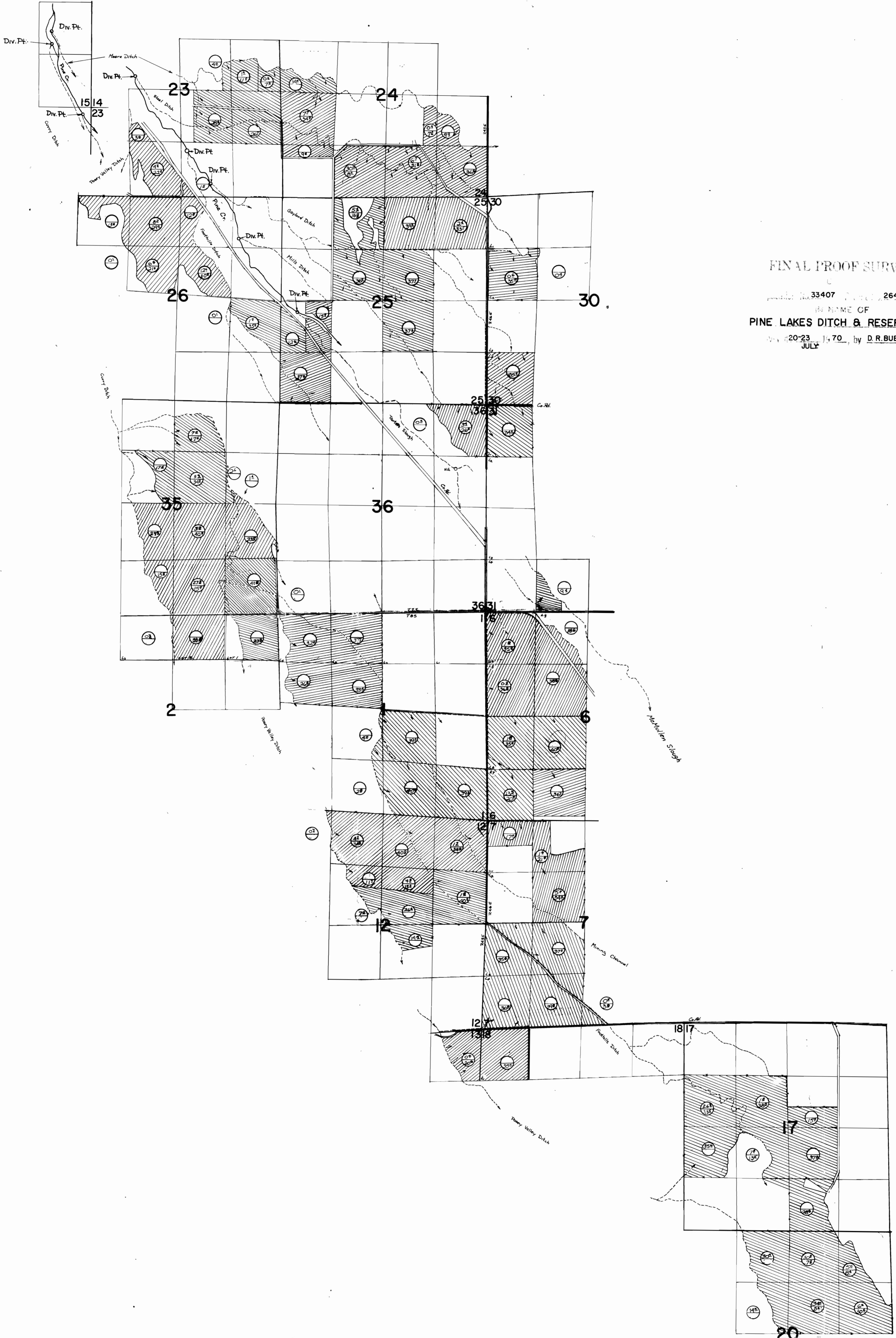

FINAL PROOF SURVEY

Books 33407 & 26491

IN NAME OF

PINE LAKES DITCH & RESERVOIRS CO.

July 20-23, 1970, by D. R. BUELL

○ Primary  
○ Supplemental

Div. Pt. loc. See 58 & NW Sec. 10, T. 6 S. R. 46 E. W.M.; Pine Cr. 1430' N & 1020' W, 1620' N & 1010' W, 170' S & 200' W all from SE Cor. Sec. 15, also 3050' N & 3780' W, 1170' N & 3450' W, 350' N & 1830' W, 1050' N & 1100' W, 2100' S & 400' E all from N.E. Cor. 24, T. 7 S. R. 46 E. W.M.