

6-8516
67506
1 of 2

CrownZellerbach
Northwest Timber Operations

- LOGGING CONTRACT
- CONSTRUCTION CONTRACT
- ROAD USE AGREEMENT
- TIMBER PURCHASE AGREEMENT
- EASEMENT - R/W AGREEMENT
- OTHER (SPECIFY) Water Right Permit

T-65 REV. 4/71
(POLICY #32)

TWP 29 South RANGE 8 East SEC 32 FILE _____
 DIVISION John Day-Mazama SCALE 1" = 1000' BY E.N.M.
 COUNTY Klamath STATE Oregon DATE December 1, 1976 APPROVED _____

Big Spring Creek & Thine. Wells

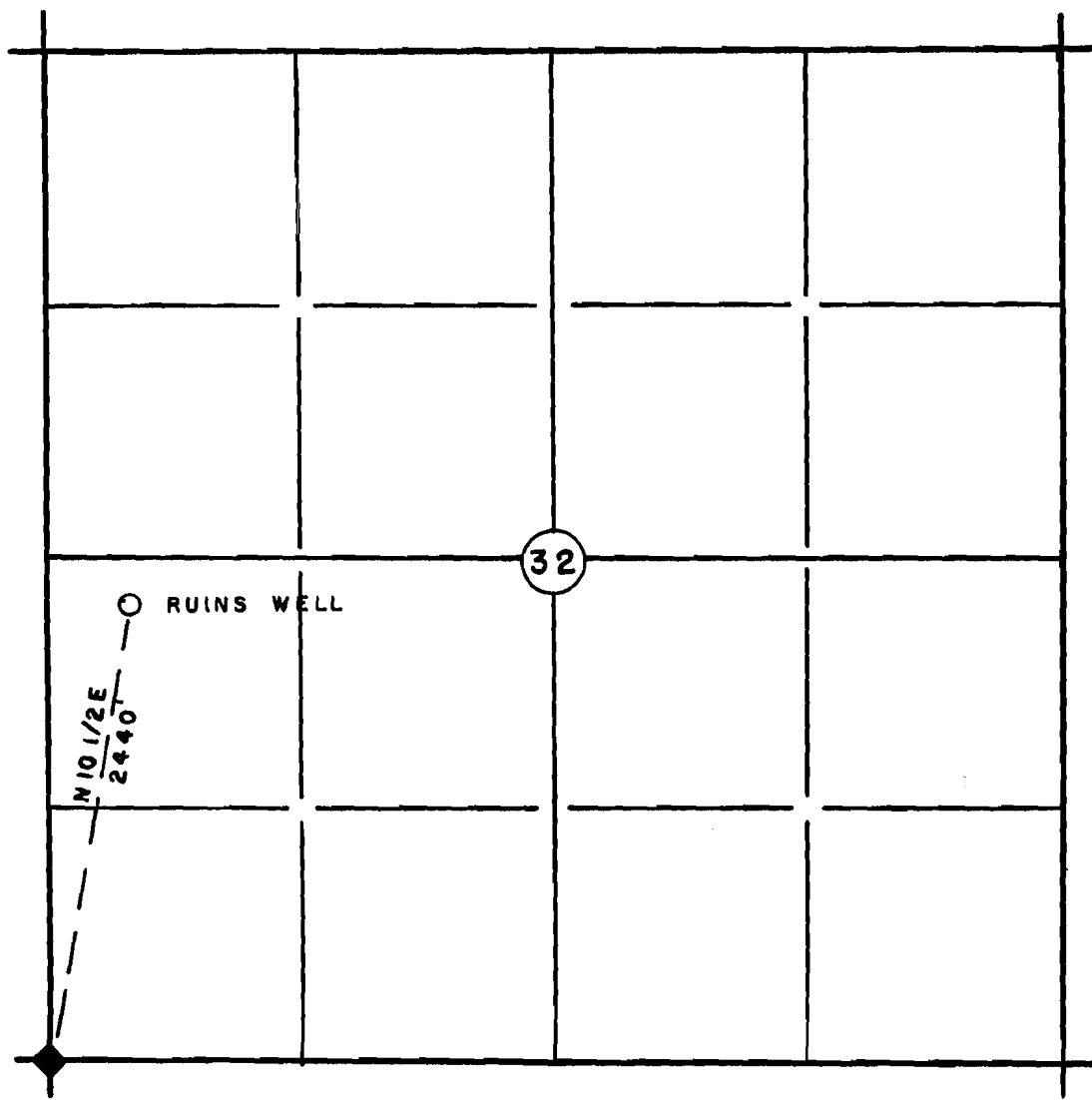

Section corner common to sections 31, 32, 5, 6 marked by brass cap on 1" pipe and 4" bearing trees

RECEIVED

DEC 1 1976

WATER RESOURCES DIV
SALEM, OREGON

Application No. G-7624
Permit No. G 8376

LEGEND

- ◆ ESTABLISHED CORNER
- ◇ APPROXIMATE CORNER
- ~ EXISTING ROAD
- - - PROPOSED ROAD
- ||||| ESTABLISHED PROPERTY LINE

AREA

Assigned 2-15-89 to:
Cavenham Forest Ind., Inc.

6-8376
67506
2 of 2

Crown Zellerbach
Northwest Timber Operations

T-65 REV. 4/71
(POLICY #32)

- LOGGING CONTRACT
- CONSTRUCTION CONTRACT
- ROAD USE AGREEMENT
- TIMBER PURCHASE AGREEMENT
- EASEMENT - R/W AGREEMENT
- OTHER (SPECIFY) Water Right Permit

TWP 20 South RANGE 8 East SEC 32 FILE _____
 DIVISION John Day-Mazama SCALE 1" = 1000' BY E.N.V.
 COUNTY Klamath STATE Oregon DATE December 1, 1976 APPROVED _____

Big Spring We; misc. wells

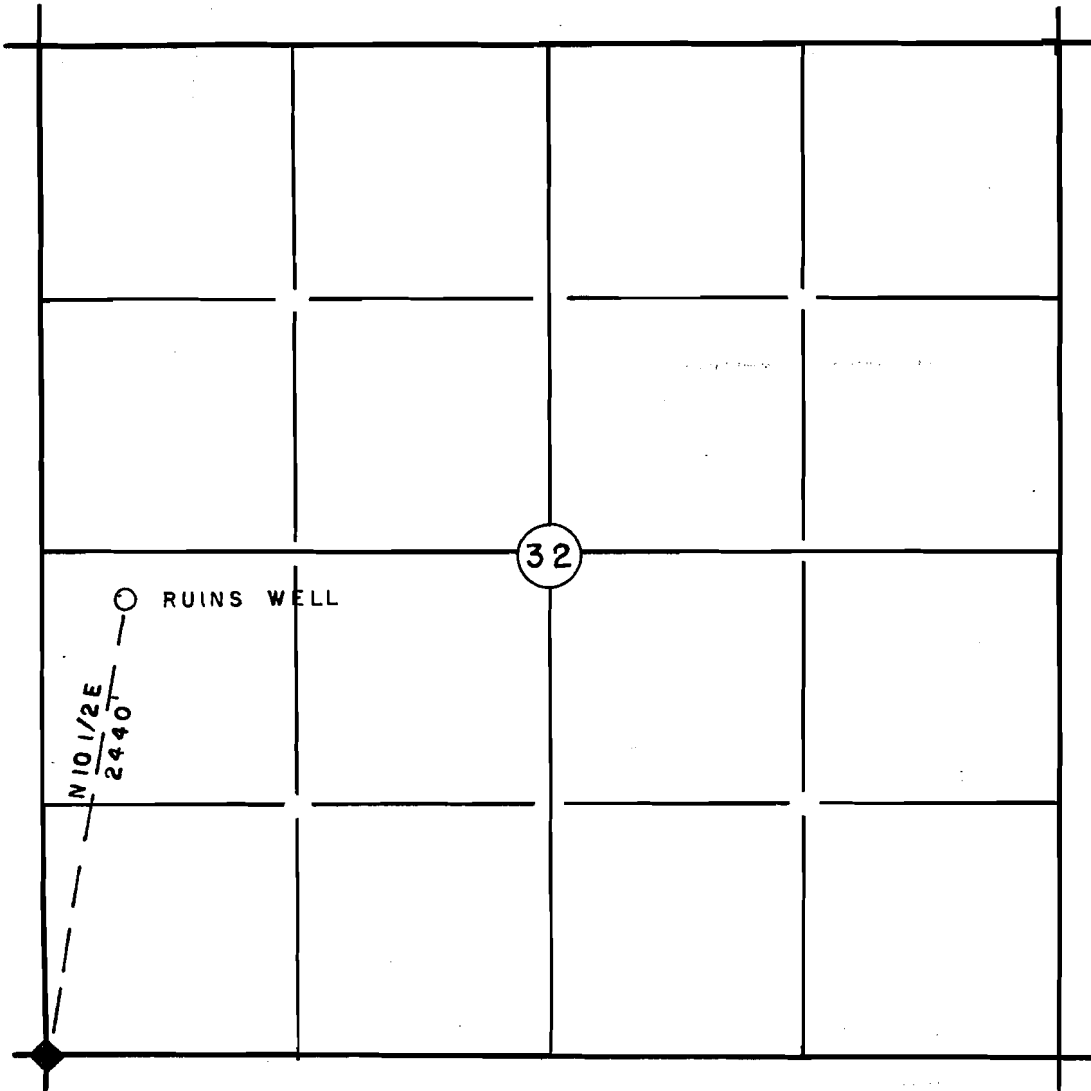

Section corner common to sections 31, 32, 5, 6 marked by brass cap on 1" pipe and 4 bearing trees

RECEIVED

DEC 01 1976

WATER RESOURCES DIVISION
SALEM, OREGON

Application No. G-7624
Permit No. G 8376

LEGEND

- ◆ ESTABLISHED CORNER
- ◇ APPROXIMATE CORNER
- ~~~~~ EXISTING ROAD
- PROPOSED ROAD
- ===== ESTABLISHED PROPERTY LINE

AREA
