

SECTION 20, T.33S., R.2E., W.M.

RECEIVED

NOV 16 1989

WATER RESOURCES DEPT.  
SALEM, OREGON

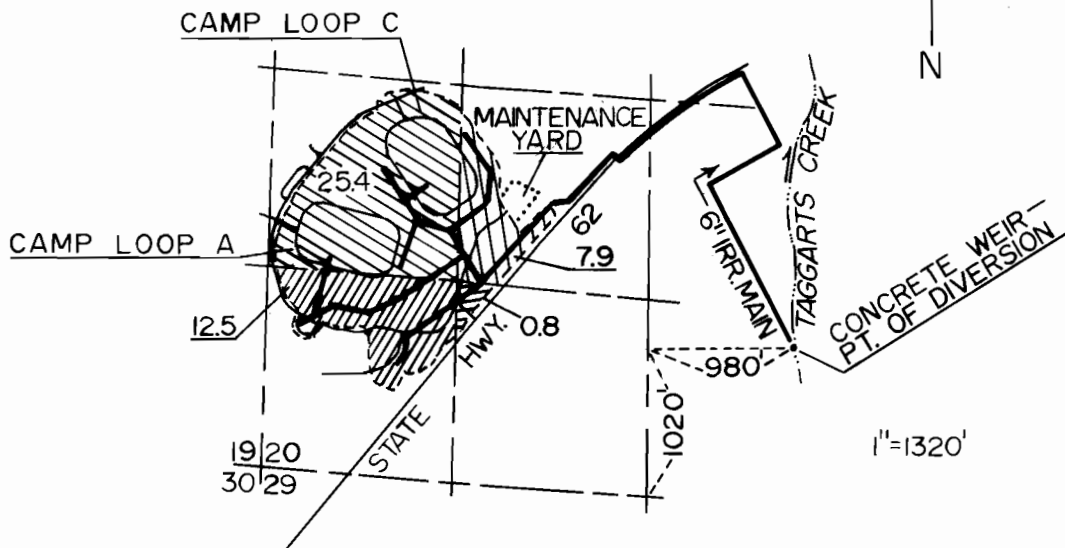

FINAL PROOF SURVEY  
UNDER

Application No. 69711 Permit No. 50624

IN NAME OF  
OREGON STATE PARKS DIVISION

Surveyed 9-20, 1989

by Arnold N. Slack

THE PURPOSE OF THIS MAP IS TO IDENTIFY THE LOCATION OF THE WATER RIGHT. IT IS NOT INTENDED TO PROVIDE INFORMATION RELATIVE TO THE LOCATION OF PROPERTY OWNERSHIP BOUNDARY LINES.

