

T. 35S., R. 14E., W.M.

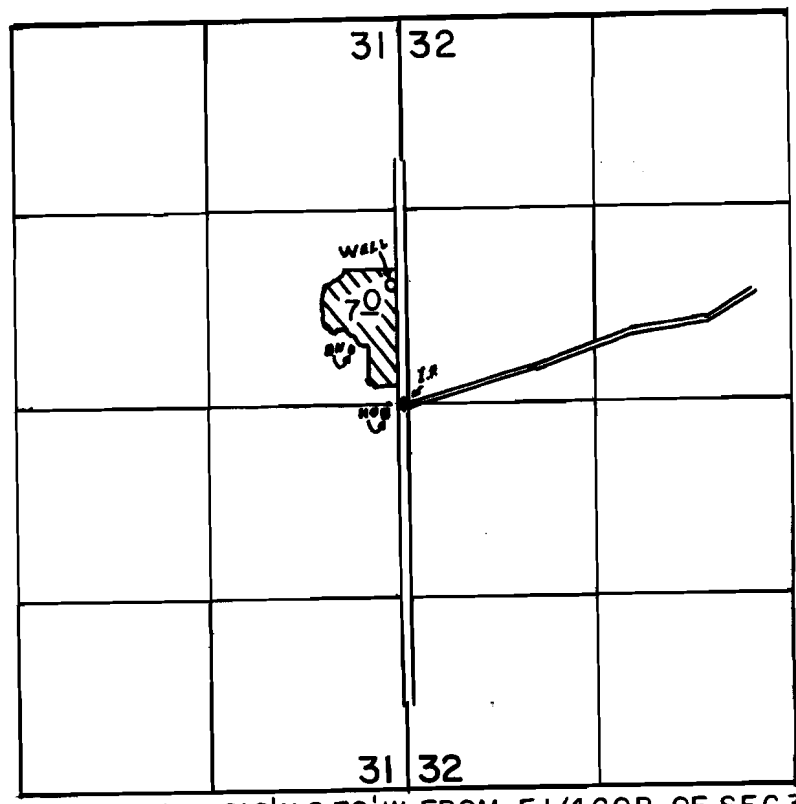

WELL LOC.: 810' N. & 70' W. FROM E 1/4 COR. OF SEC. 31.

SCALE: 1" = 1320'

**FINAL PROOF SURVEY  
UNDER**

Application No. G-6234 Permit No. G-5881.....  
IN NAME OF

.....HARRY & INEZ LOBENCHAIN.....

Surveyed MAY 20, 1991, by B.W. BISHOP..

W. E. Spangue River Wells