

G-10641

RECEIVED 67670

T13S R33E WM

JUL 28 1986

City of Prairie City

WATER RESOURCES DEPT
SALEM, OREGON

Application No. *D-11563*
Permit No. G10641

DUKE

N

4" = 1 mil

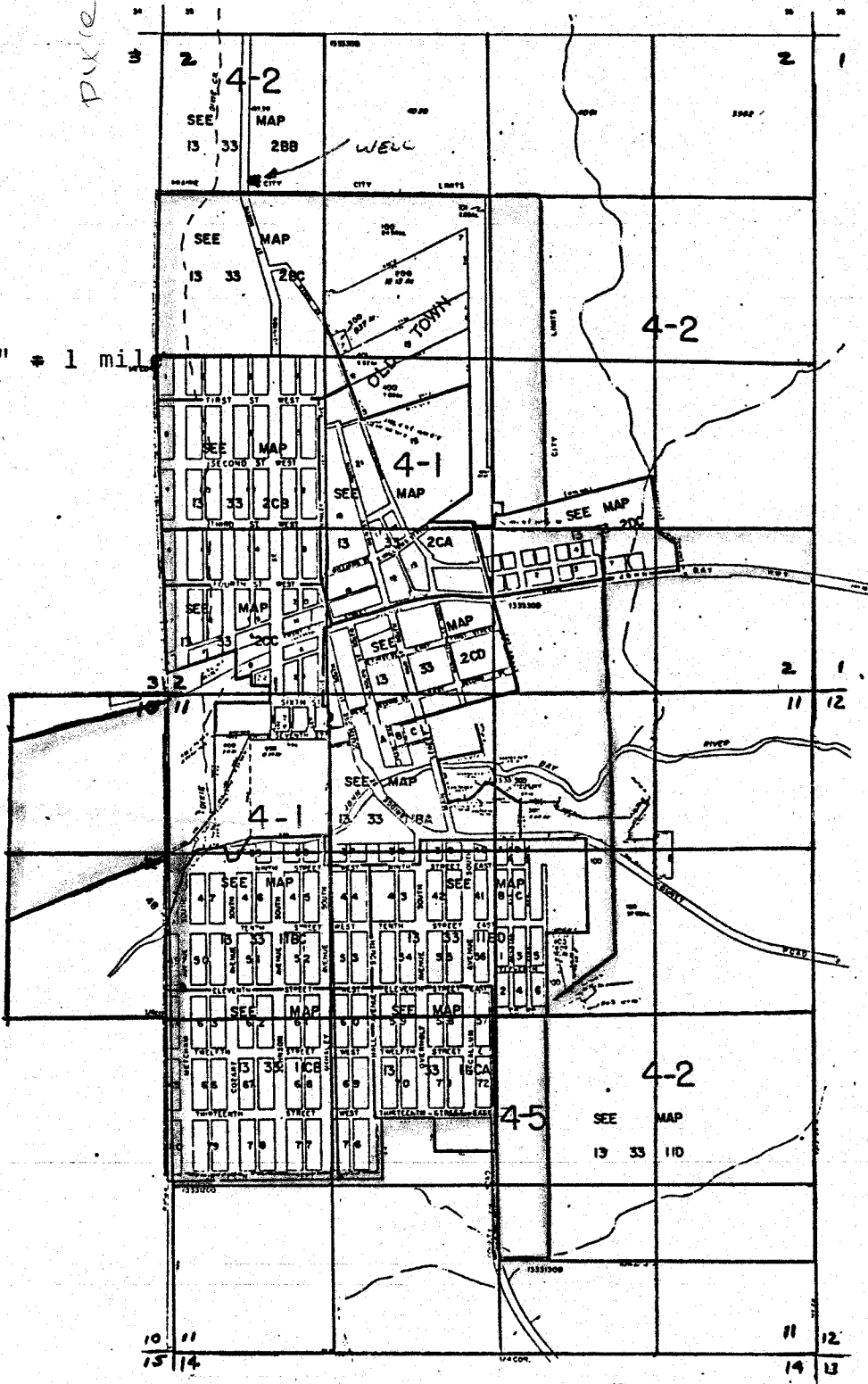

Well is located
1200'S & 700'E
from NW corner
of Sec. 2