

1" = 1320'

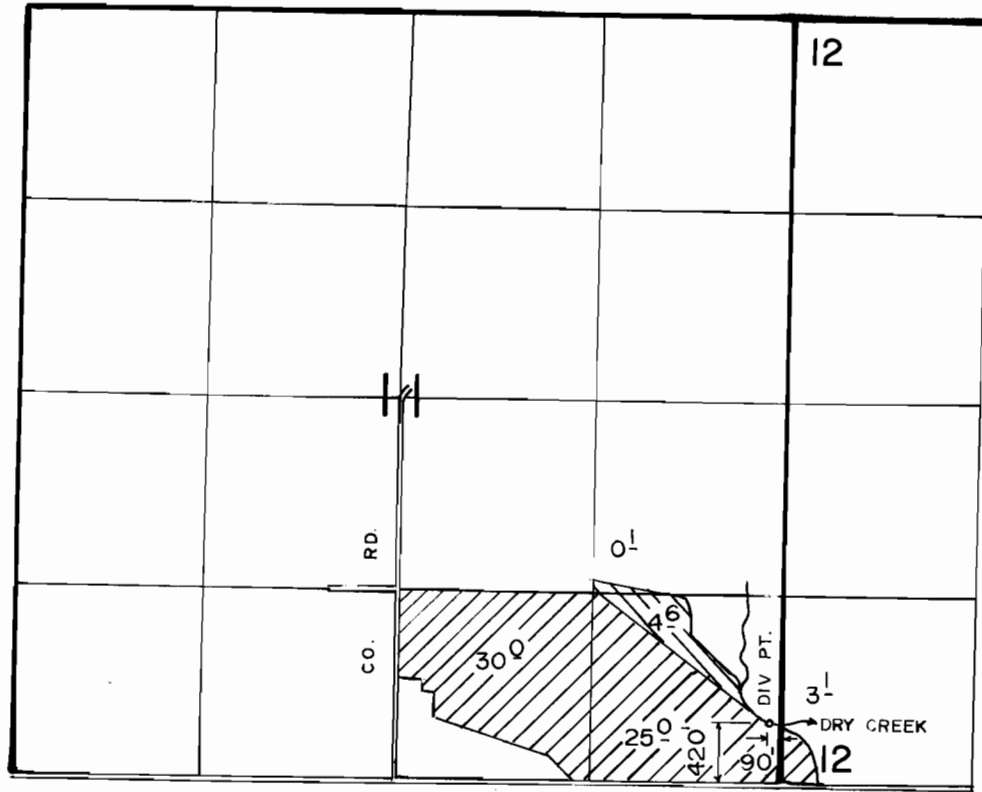

T. 8 S., R. 46 E., W.M.

 SUPPLEMENTAL
 PRIMARY

FINAL PROOF SURVEY
UNDER

Application No. 63547 Permit No. 47445.....
IN NAME OF

GORDON W SUMMERS

Surveyed MAY 22 1990, by V L CHURCH

12-26-90 DSM
41001-179-53R