

FINAL PROOF SURVEY

UNDER

APPLICATION No. 69697 PERMIT No. 50685



IN THE NAME OF:
Dorothy L. Wilson
1600 Chestnut Ave N
Nyssa, OR 97913

SCALE 1" = 1320'

T19S R47E

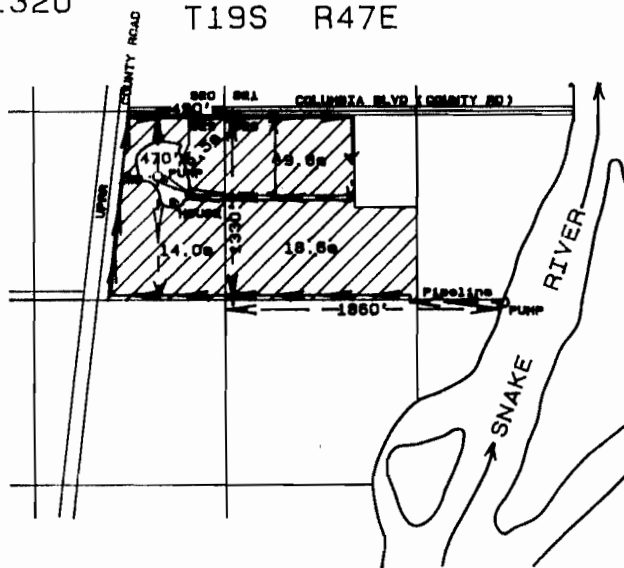

Surveyed June 1, 1990

Ditches —————>

Pipelines - - - - ->

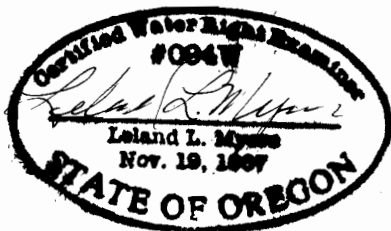

This map is for the purpose of identifying the location of the water right only and has no intent to provide dimensions or location of property ownership lines.