

6772

T.2N., R.33E., WM.

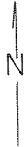
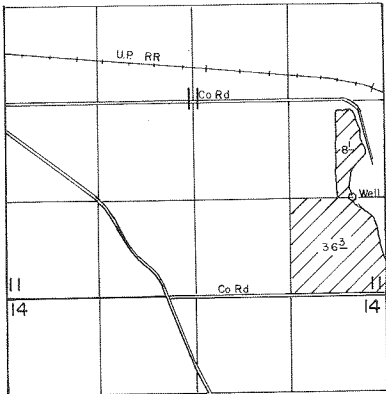

Well Located 1320' N & 490' W From SE Corner Section 11

SCALE: 1" = 1320'

**FINAL PROOF SURVEY**  
UNDER

Application No. G-10045... Permit No. G-2922...  
IN NAME OF

GORDON MUNCK

Surveyed JUNE 8... 1989, by V.L. CHURCH