

T. 12 S., R. 5 W., W.M.

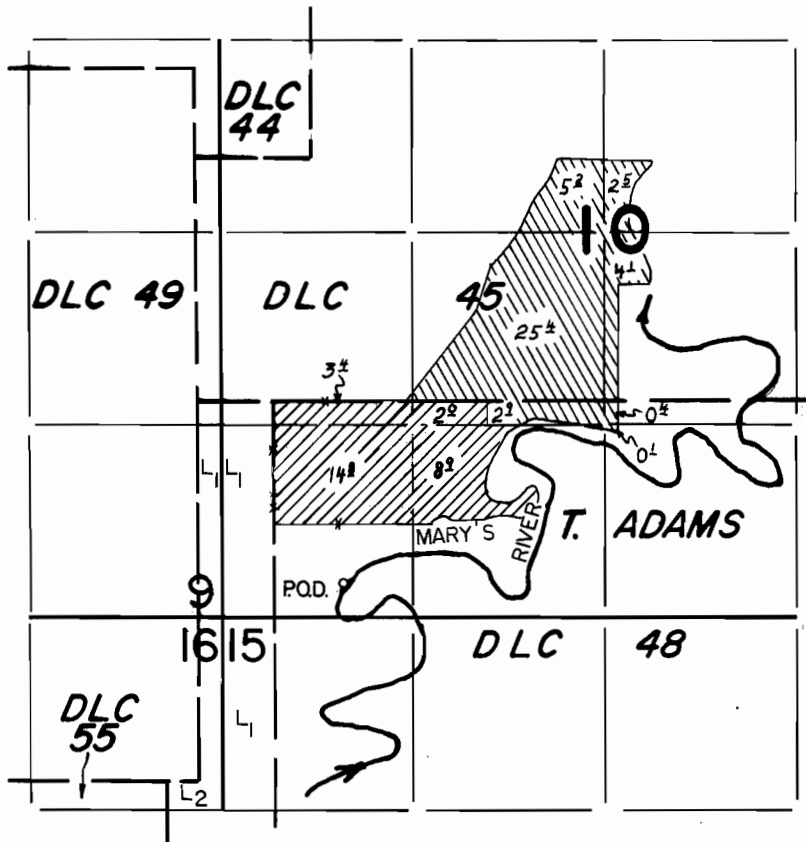

P.O.D. Loc.: 1250' S. & 470' E. from NW Cor. DLC 48.

Scale: 1" = 1320'

FINAL PROOF SURVEY UNDER

Application No.	68970	Permit No.	49969	
	67093		48140	

IN NAME OF

Ramon J. & Katherine Seidler

Mar 15 91 R. W. Klassen

Surveyed May 6 1987, by T. Warren