

T. 31 S. R. 4 W. W.M.

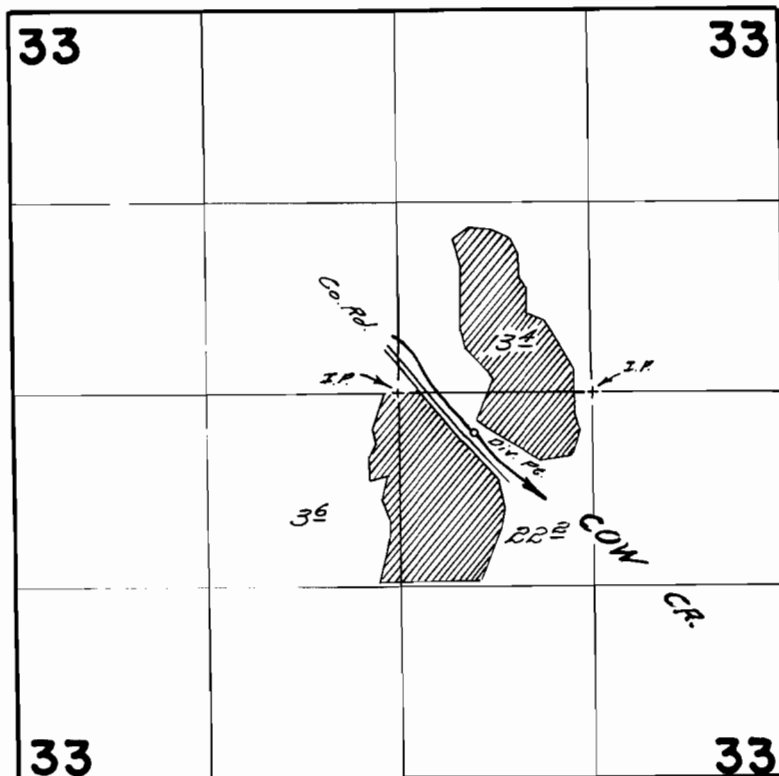

DIVERSION POINT LOCATED 280 P.S. & 450 P.S. FROM
CENTER 1/4 CORNER SECTION 33

FINAL PROOF SURVEY
UNDER

Application No. 35526 Permit No. 27501
IN NAME OF

ROSS M. LENT

Surveyed April 28, 1968, by *W. d. Ruppert*