

# T. 3. S., R. 4 W. W.M.

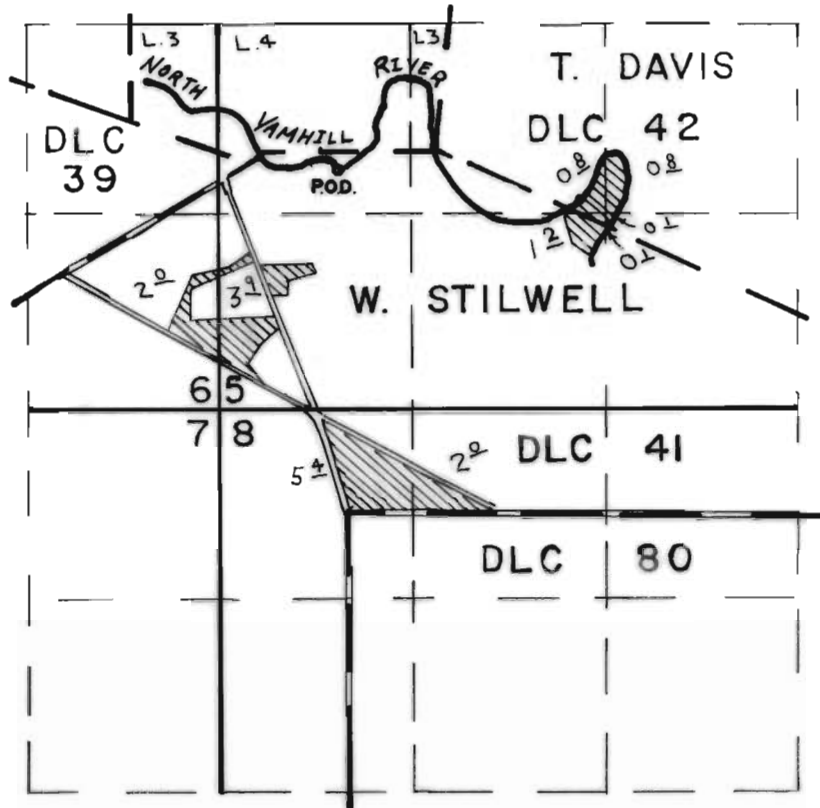

DIV. PT. LOC.: 1630' N. & 830' E. OF SW COR. SEC. 5

## FINAL PROOF SURVEY UNDER

Application No. 58958 Permit No. 44538  
IN NAME OF

JACK D. FROST

Surveyed JUL 10 1984, by P. PAGTER