

SIDE VIEW  
NO SCALE

TOP VIEW  
NO SCALE

PROPOSED WEIR  
PHASE II  
SEE DETAIL  
PHASE II

COLUMBIA RIVER

PHASE I  
PUMP STATION  
4" TO RIVER  
37 (180 L.F.)

4" SUCTION LINE  
TO RIVER

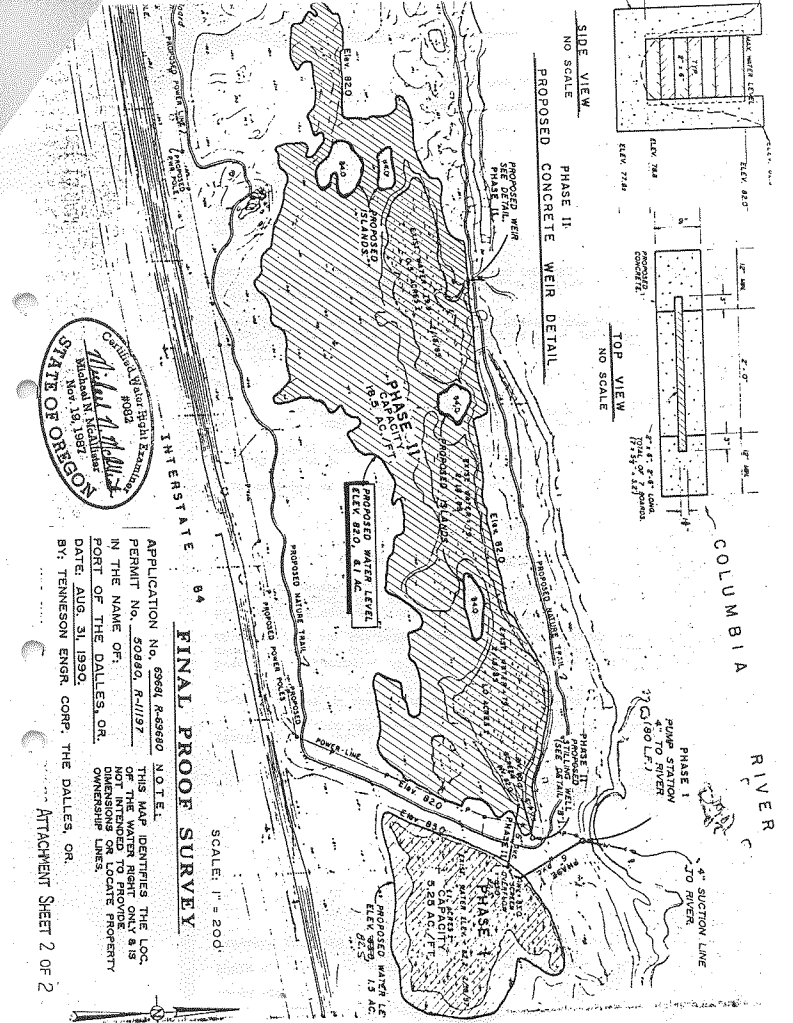

SCALE: 1" = 200'

**FINAL PROOF SURVEY**

INTERSTATE 84

APPLICATION No. 69681, R-69680 NOTE L.  
PERMIT No. 50880, R-11/197  
IN THE NAME OF:  
PORT OF THE DALLES, OR.

THIS MAP IDENTIFIES THE LOC  
OF THE WATER RIGHT ONLY & IS  
NOT INTENDED TO PROVIDE  
DIMENSIONS OR LOCATE PROPERTY  
OWNERSHIP LINES.

DATE: AUG. 31, 1990.

BY: TENNISON ENGR. CORP. THE DALLES, OR.

ATTACHMENT SHEET 2 OF 2



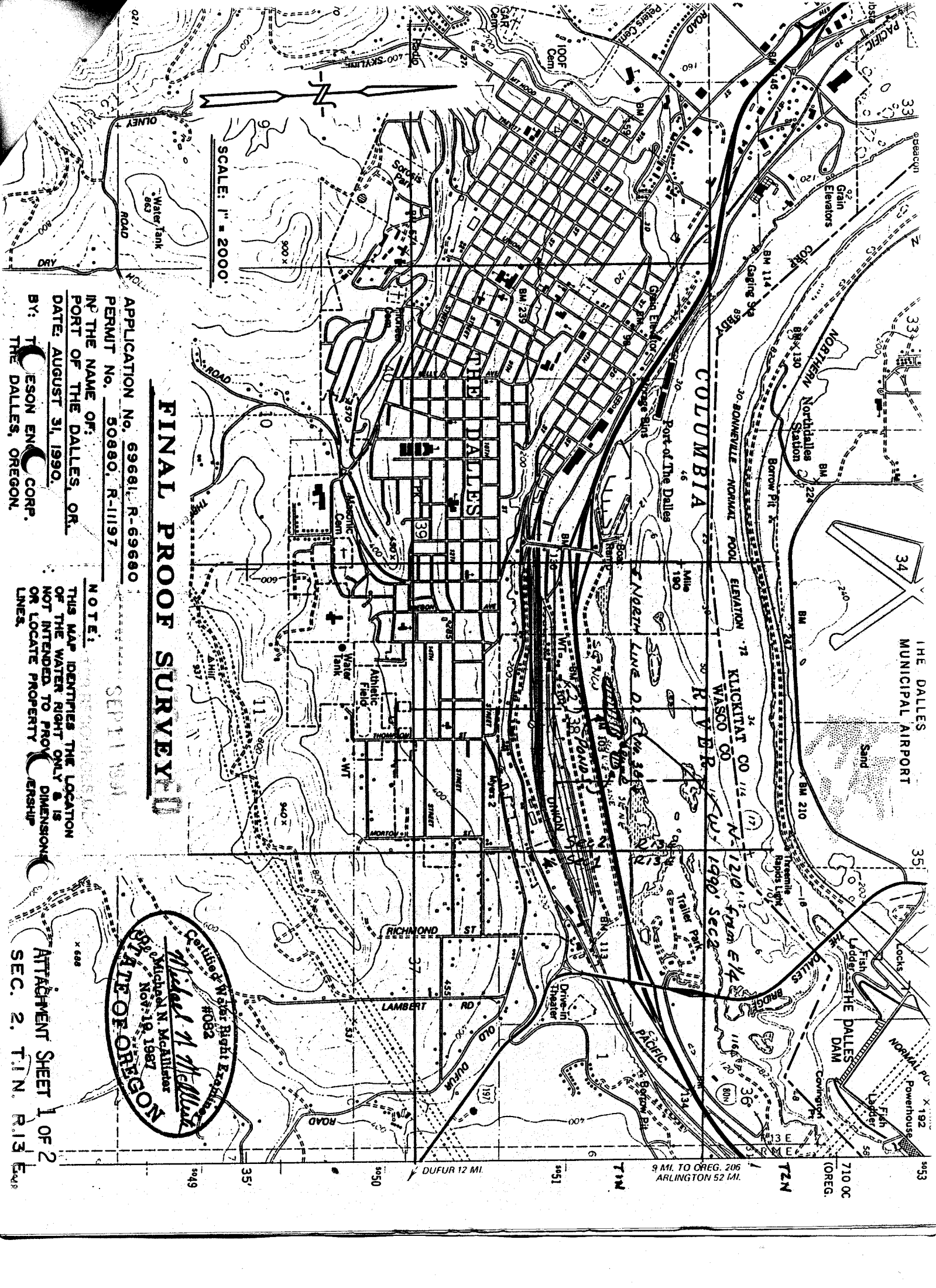

SCALE: 1" = 2000'

**FINAL PROOF SURVEY**

APPLICATION No. 69681, R-69680  
 PERMIT No. 50880, R-11197

IN THE NAME OF:  
 PORT OF THE DALLES, OR.  
 DATE: AUGUST 31, 1990.  
 BY: T. J. EASON ENGINEERING CORP.  
 THE DALLES, OREGON.

**NOTE:**

THIS MAP IDENTIFIES THE LOCATION OF THE WATER RIGHT ONLY & IS NOT INTENDED TO PROVE DIMENSIONS OR LOCATE PROPERTY INTERESTS.

SEPT 1 1991

Certified to State of Oregon  
 Michael J. McCallister  
 No. 19, 1987  
 STATE OF OREGON

ATTACHMENT SHEET 1 OF 2  
 SEC. 2, T.1N, R.13E

9 MI. TO OREG. 206  
 ARLINGTON 52 MI.

THE DALLES MUNICIPAL AIRPORT

THE DALLES DAM

5048

5049

5050

5051

T1N

T2N

710 OC

5053