

56072 G-7145

67878  
**RECEIVED**

**T. 2N., R. 27E., W. M.**

MAR 20 1987

WATER RESOURCES DEPT.  
SALEM, OREGON

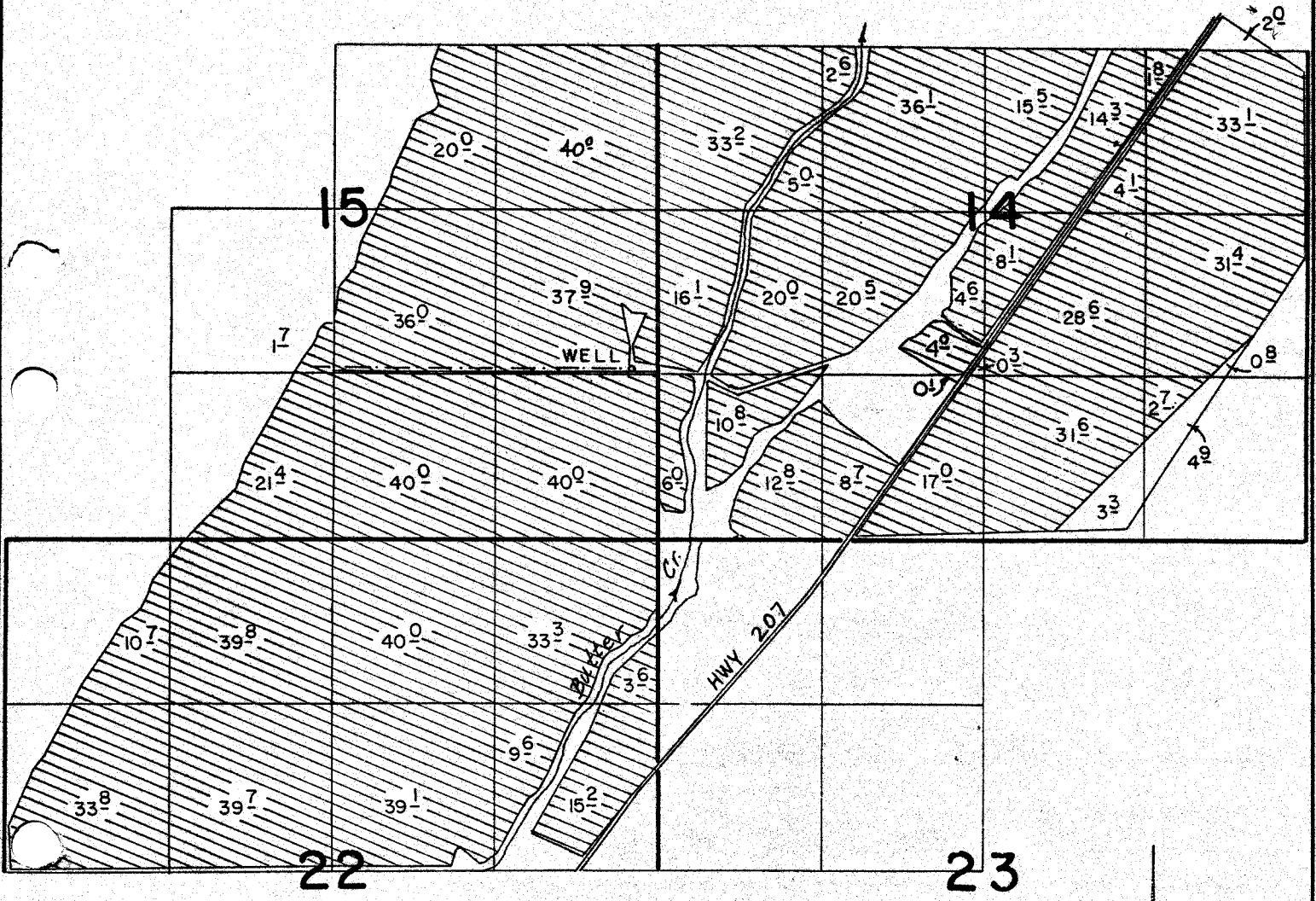

WELL LOCATED 138'0" N. & 210' W. FROM SE COR. SEC. 15

**FINAL PROOF SURVEY**  
UNDER

Application No. **G:7643** Permit No. **G:7145**...  
IN NAME OF

**J. & M. WATER WORKS**

Surveyed **11-18** 19**85**, by **V.L. CHURCH**

SCALE: 1" = 1320'

REV. 11-7-86 SL  
REV. 10-23-86 VLL

61R, 62R

VLC.