

T.2N. R.11 & 12E. W.M.

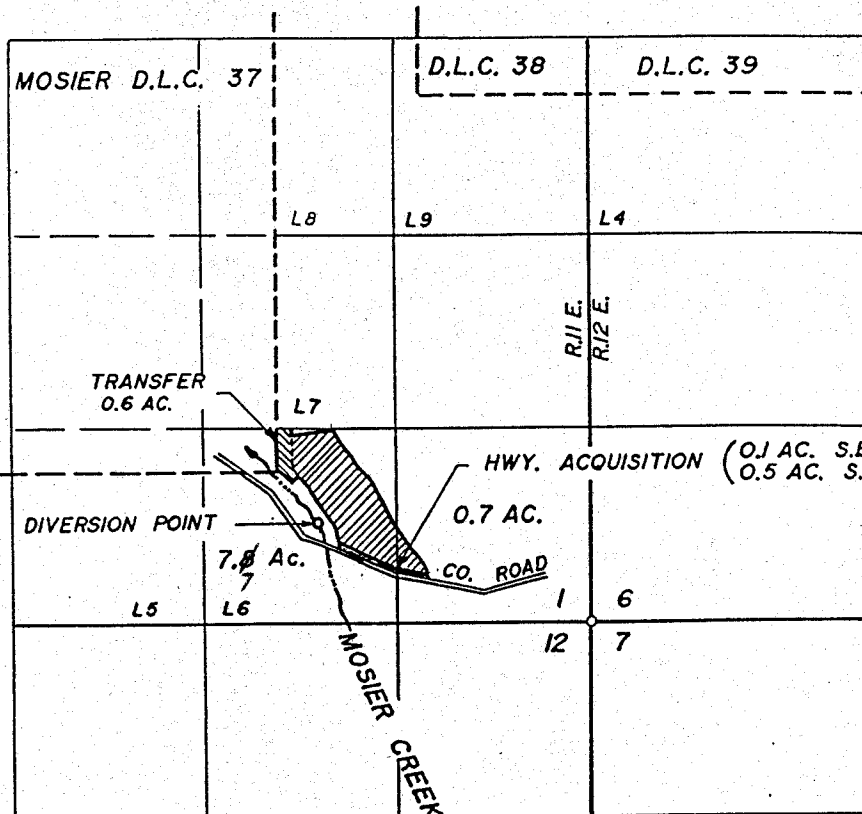

DIVERSION POINT LOCATED 680' N. & 1880' W. FROM S.E. COR. SEC.1.

APPLICATION MAP
FOR WATER RIGHT TRANSFER

CERTIFICATE No. 43084 PERMIT No. 33321

IN THE NAME OF
MANVIL TROXEL

NOVEMBER 8, 1988,

BY TENNESON ENGINEERING CORP.
THE DALLES, OREGON.

MAP FROM FINAL PROOF SURVEY,
PERMIT No. 33321 BY D. NORBY,
APRIL 26, 1988.

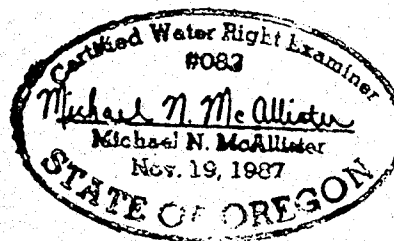

NOTE:

THIS MAP IDENTIFIES THE LOCATION OF THE
WATER RIGHT ONLY, AND IS NOT INTENDED TO
PROVIDE DIMENSIONS OR LOCATE PROPERTY
OWNERSHIP LINES.