

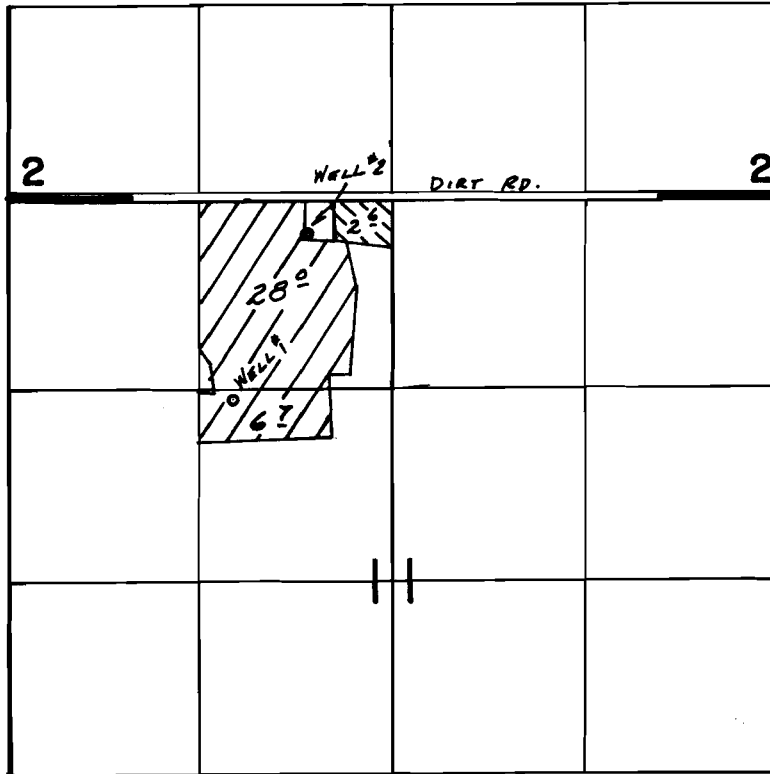

T. 26 S., R. 18 E., W.M.

G-9170  
67907



WELLS LOC: #1- 1380'S. & 240'E., #2- 250'S. & 730'E., BOTH FROM NW COR. NE\*NW\*, SEC. 11.

 WELL #1

 WELL #2

SCALE: 1"=1320'

FINAL PROOF SURVEY

UNDER

Application No. G-10094 Permit No. G-9170  
IN NAME OF

GREGORY TODD PHIPPS

Surveyed APRIL 20, 1992, by B.W. BISHOP