

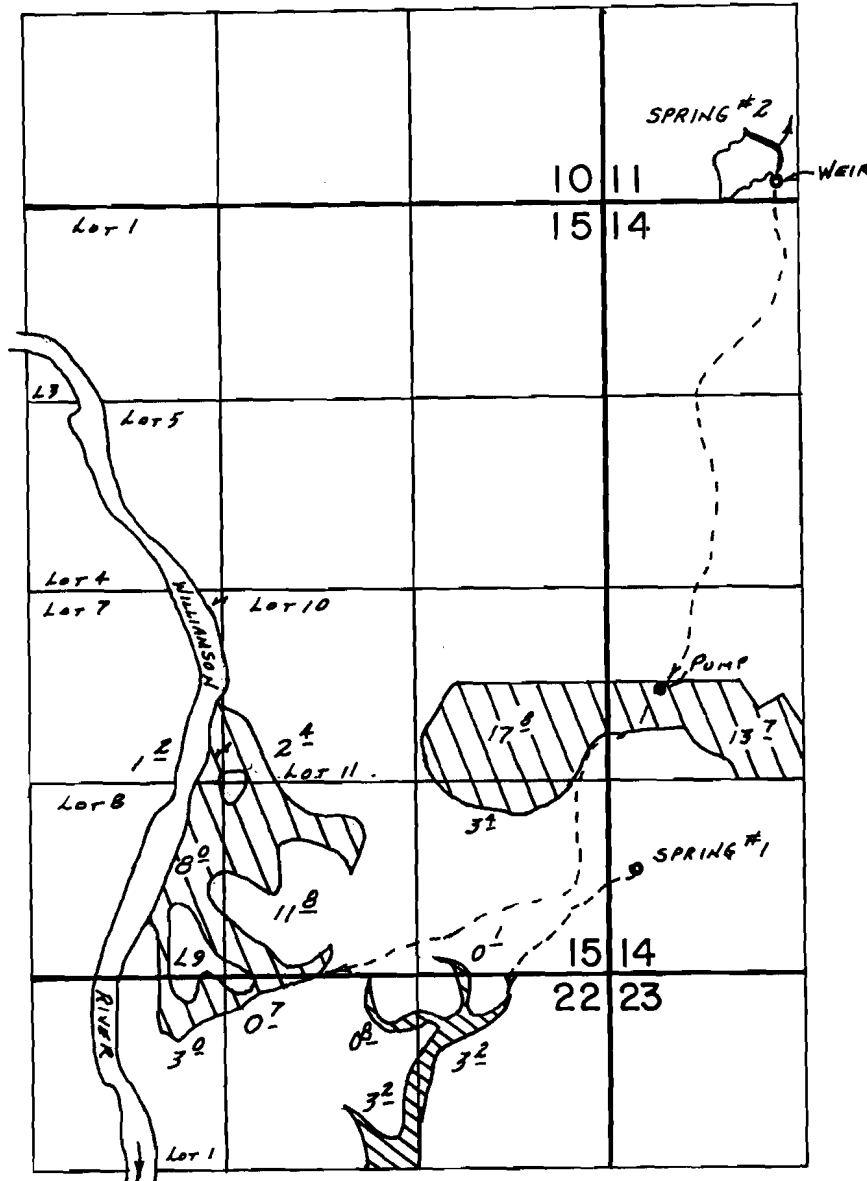

T. 34S., R. 7E., W.M.



SPRING #1 LOC: 700' N & 200' E FROM SW COR. SEC. 14 
 SPRING #2 LOC: 350' N. & 1200' E FROM SW COR. SEC. 11 

FINAL PROOF SURVEY
UNDER

Application No. 60327 Permit No. 45127.....
 IN NAME OF

KENNETH L. & KAREN L. TUTTLE

Surveyed Sept. 11, 1986, by B.W. BISHOP...

W.M. To Blv. to Marsh Mic