

T. 6N., R. 35E., W. M.

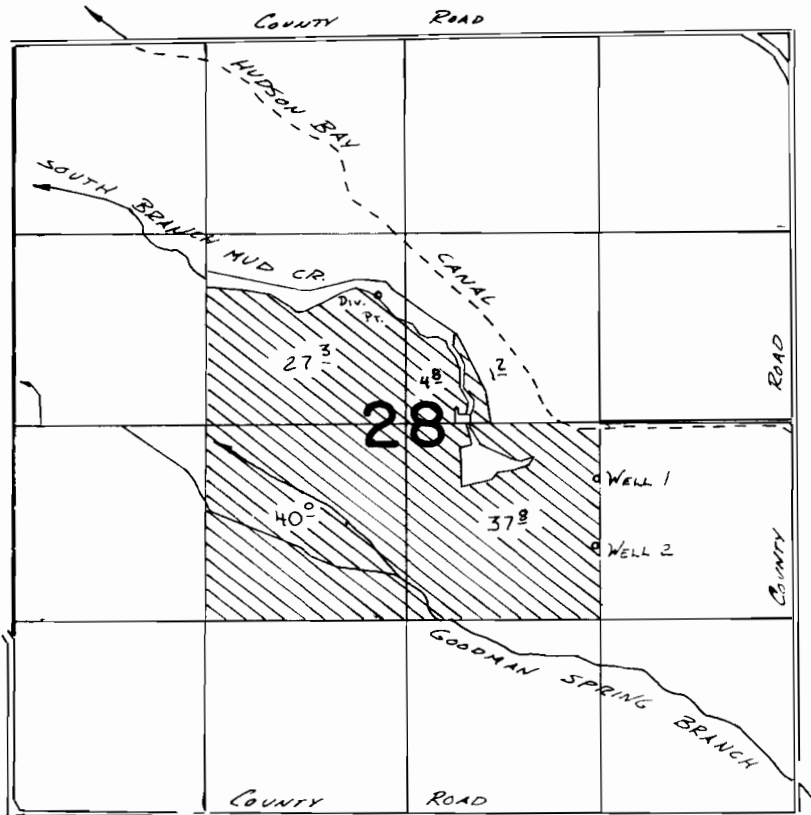

Scale 1" = 1320'

WELL 1 LOCATED 390'S. & 1310'E FROM CENTER SECTION 28
 WELL 2 LOCATED 850'S. & 1300'E FROM CENTER SECTION 28
 DIV. PT. LOCATED 890'N. & 190'W. FROM CENTER SECTION 28

FINAL PROOF SURVEY UNDER

TRANSFER 3937
 G-10179 G-9222
 Application No. G-8578 Permit No. G-7914.....
 IN NAME OF

.....LOUIS.....JAMES.....HOPKINS.....

Surveyed 8-16-82, 19-82, by V.L.C. Churrah.....
 4-30 84