

T.26S.,R.5W.,W.M.

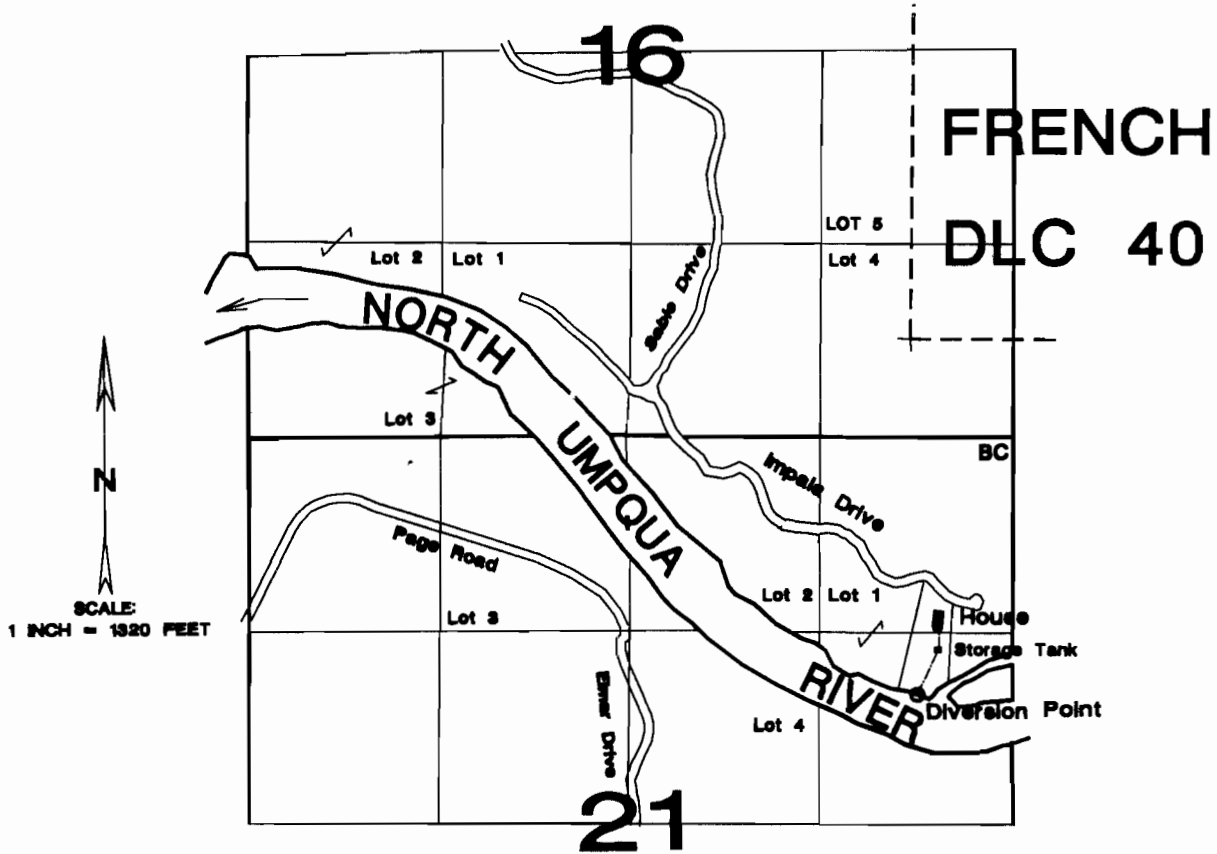

Diverson Point is located 1770' S. & 640' W. from NE Sec. Cor.

FINAL PROOF SURVEY MAP
for
DAVID LUND
APPLICATION 70360
PERMIT 51107

THE PURPOSE OF THIS MAP IS TO IDENTIFY THE LOCATION OF THE WATER RIGHT. IT IS NOT INTENDED TO PROVIDE INFORMATION RELATIVE TO THE LOCATION OF PROPERTY OWNERSHIP BOUNDARY LINES.

