

TOWNSHIP 26 SOUTH, RANGE 8 WEST, W.M.
SECTION 1

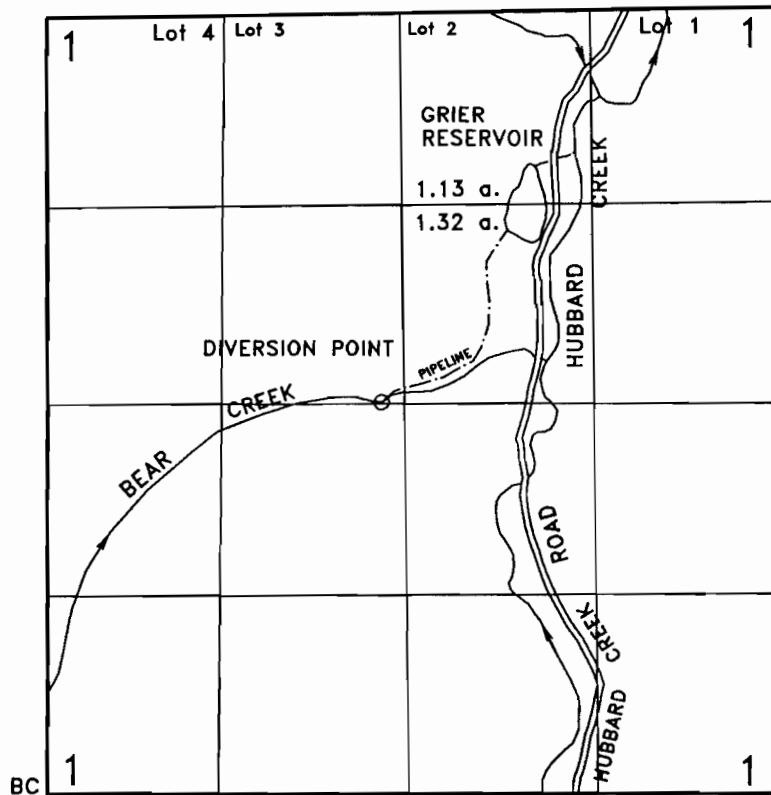
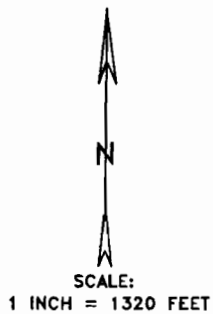

DIVERSION POINT IS 2660' N. & 2310' E. FROM SW COR. SECTION 1.

FINAL PROOF SURVEY MAP
FOR
G.W. (Bill) TIPTON

APPLICATIONS 69701 & R-69742
PERMITS 51060 & R-11244

THE PURPOSE OF THIS MAP IS TO IDENTIFY THE LOCATION OF THE WATER RIGHT. IT IS NOT INTENDED TO PROVIDE INFORMATION RELATIVE TO THE LOCATION OF PROPERTY OWNERSHIP BOUNDARY LINES.

