

T.1N.,R.6W.,W.M.

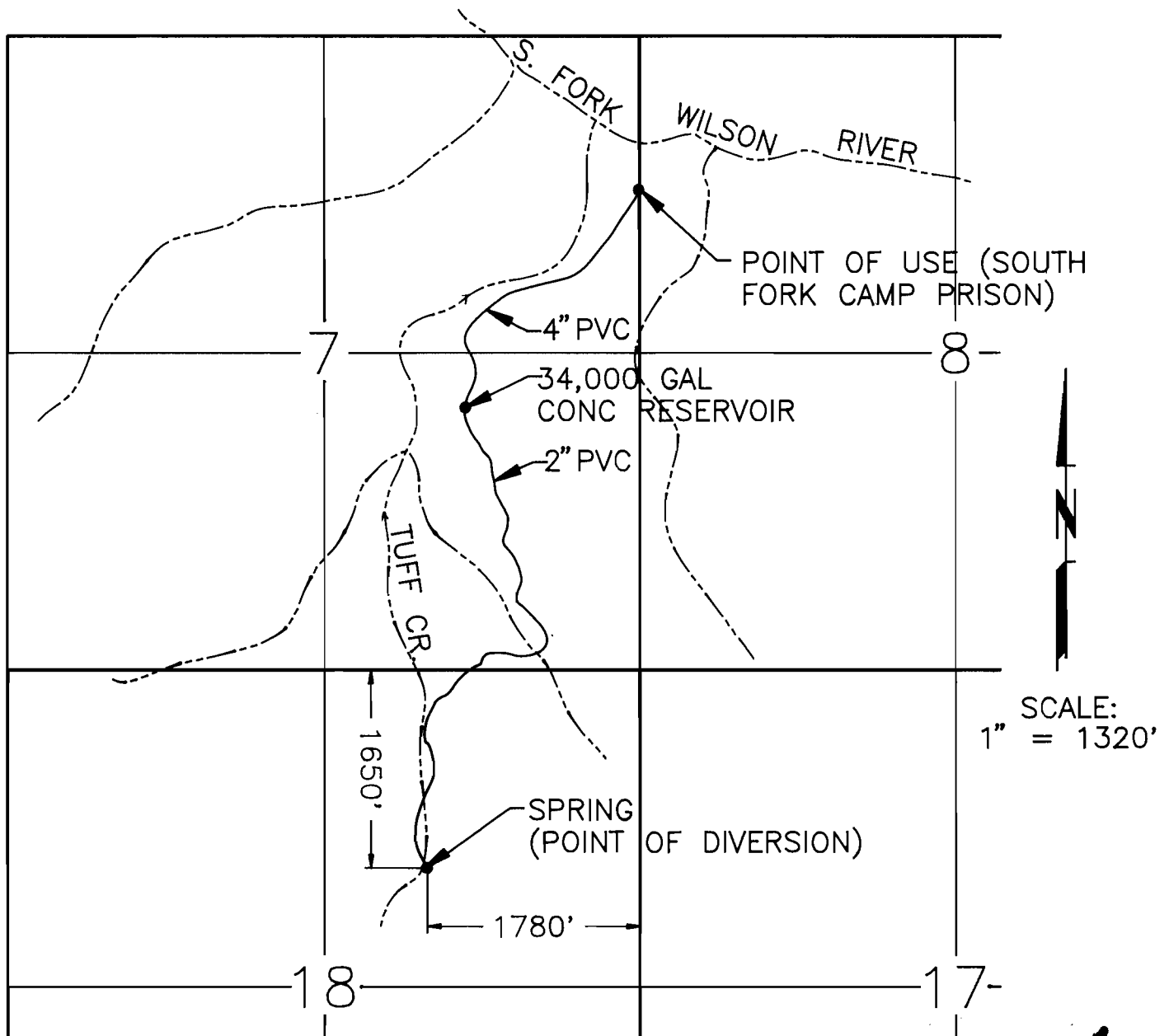

FINAL PROOF SURVEY

Chas. Smith

Application No. 69991 Permit No. 51240

6/2/92

STATE OF OREGON, DEPARTMENT OF CORRECTIONS

Surveyed JUNE 2, 1992

NOTE: This map is for the purpose of identifying the location of the water right only and is not intended to provide legal dimensions or locations of property lines.