

T. 10S., R. 2W., W.M.

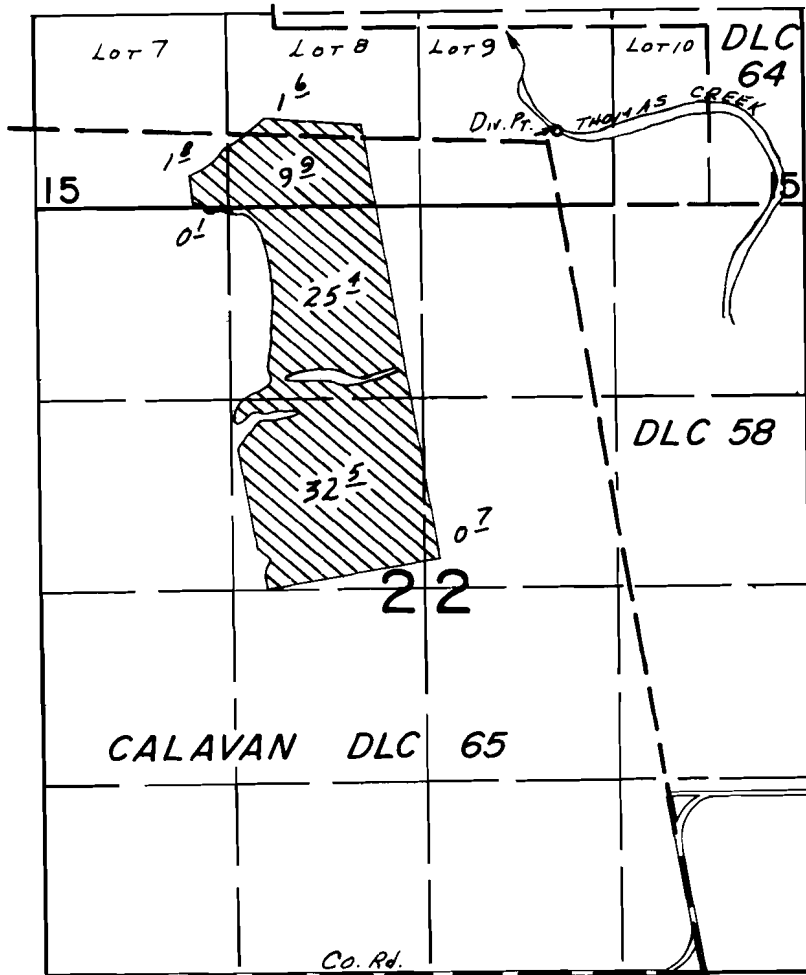

Div. Pt. Loc. 5790 N. & 940' W. FROM SE COR DLC 65

FINAL PROOF SURVEY UNDER

Application No. 55422.. Permit No. 42758.....
IN NAME OF

DEAN BOWERS

Surveyed JULY 6... 1982., by L.M. TOLL.....