

48168  
68191

**RECEIVED**

SEP 23 1983  
WATER RESOURCES DEPT.  
SALEM, OREGON

UNITED STATES  
DEPARTMENT OF THE INTERIOR  
BUREAU OF LAND MANAGEMENT

SECTION

17  
NE 1/4 SW 1/4

**Oregon State Water Filings**

TOWNSHIP 39S. RANGE 3E. W. M.

Application No. R-66703, 66704

Permit No. R 9253 48168

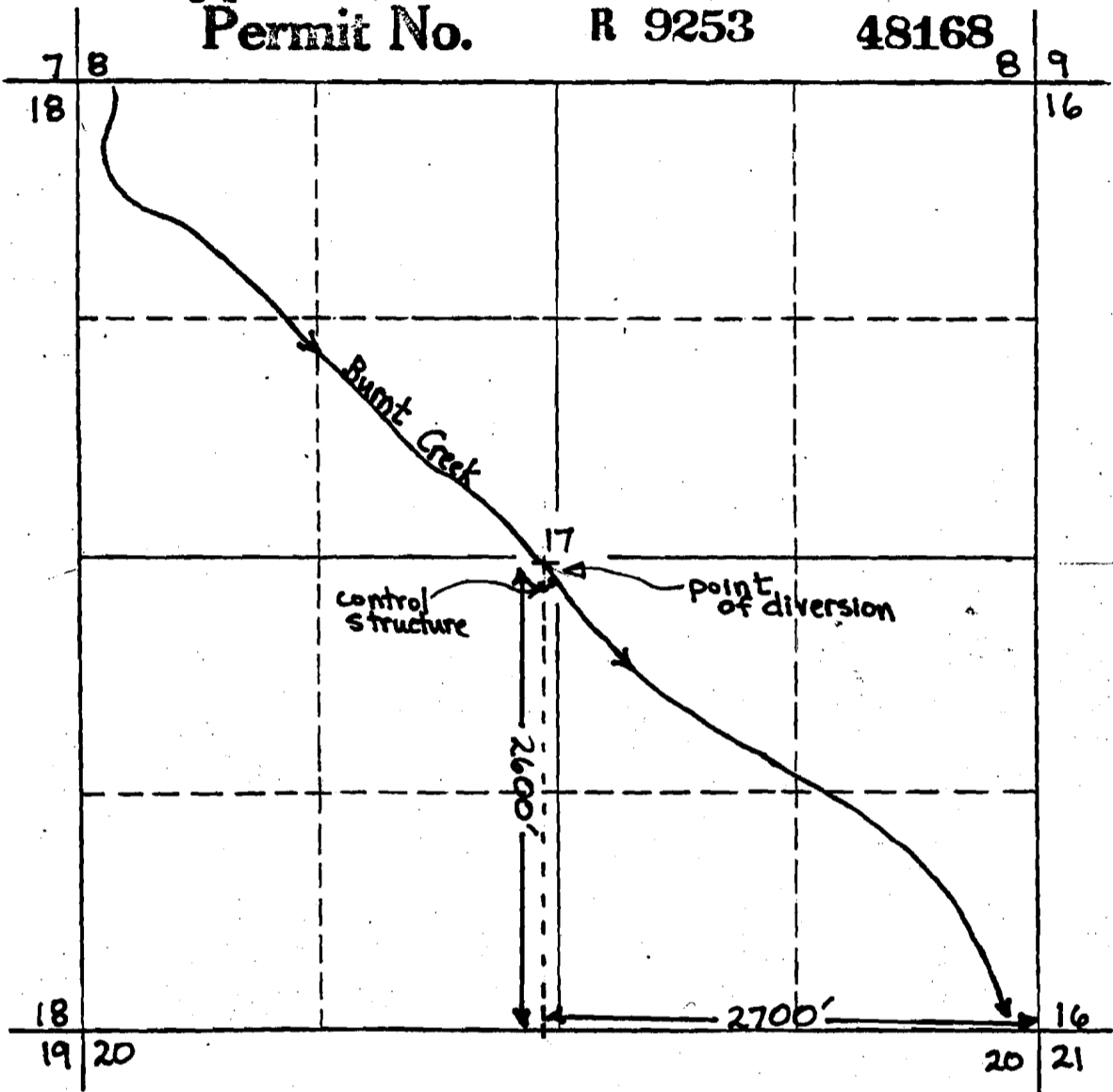

SCALE: 1" = 1000'

Enlargement  
of Diversion  
and Reservoir

