

# T.36 S., R.3 E., W.M.

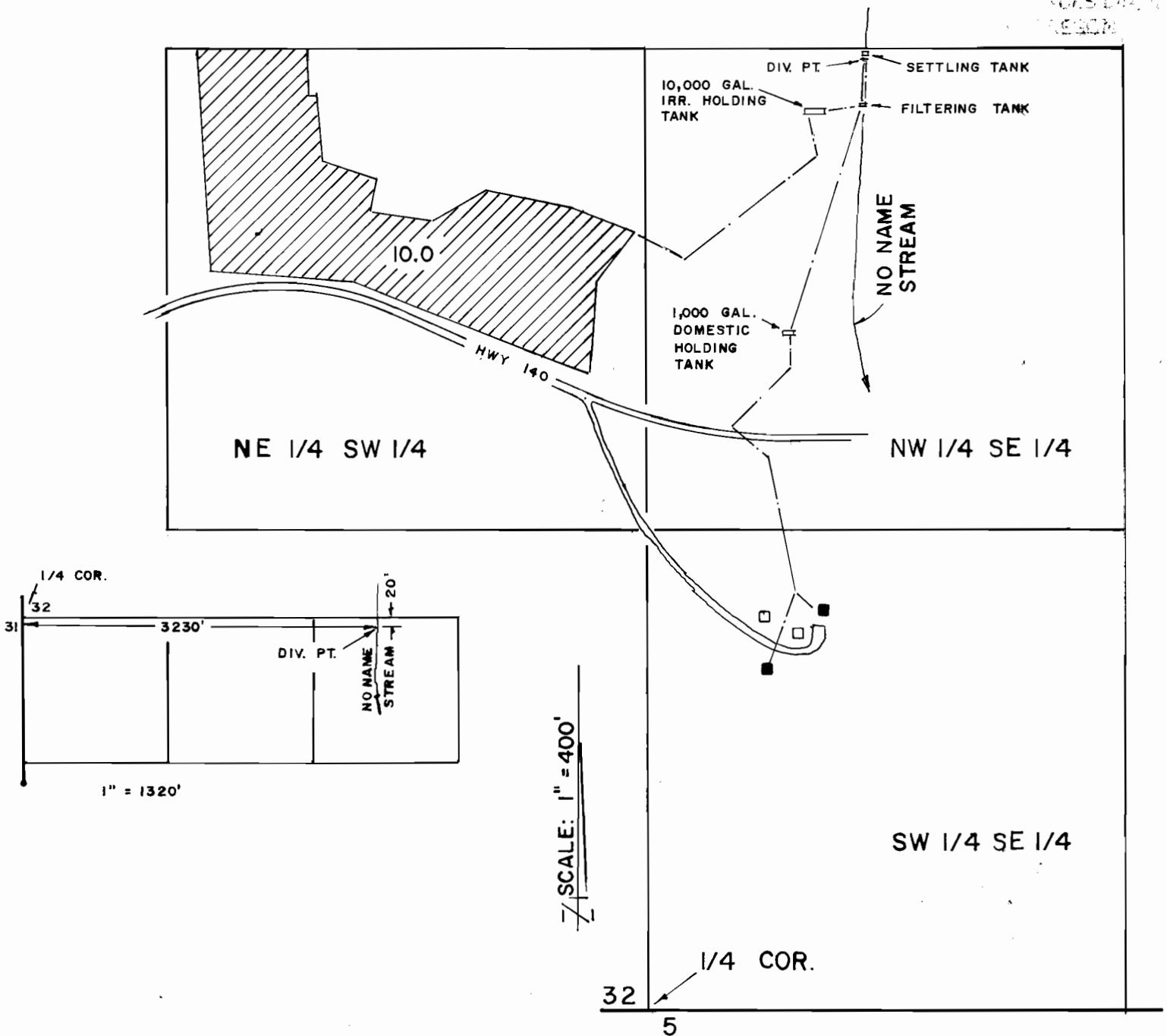

## FINAL PROOF MAP

APPLICATION No. 69620 PERMIT No. 50420

IN THE NAME OF  
BILL W. SMITH

NOTE: THIS MAP HAS BEEN PREPARED FOR WATER RIGHT PURPOSES ONLY, NOT FOR PROPERTY BOUNDARY LOCATIONS.

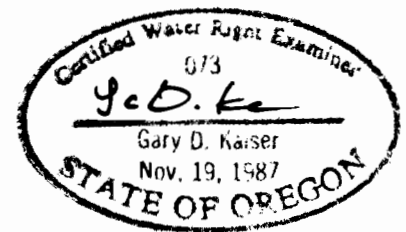

MAP PREPARED SEPTEMBER 21, 1992 BY GARY D. KAISER