

RECEIVED

OCT 30 1991

WATER RESOURCES DEPT
SALEM, OREGON

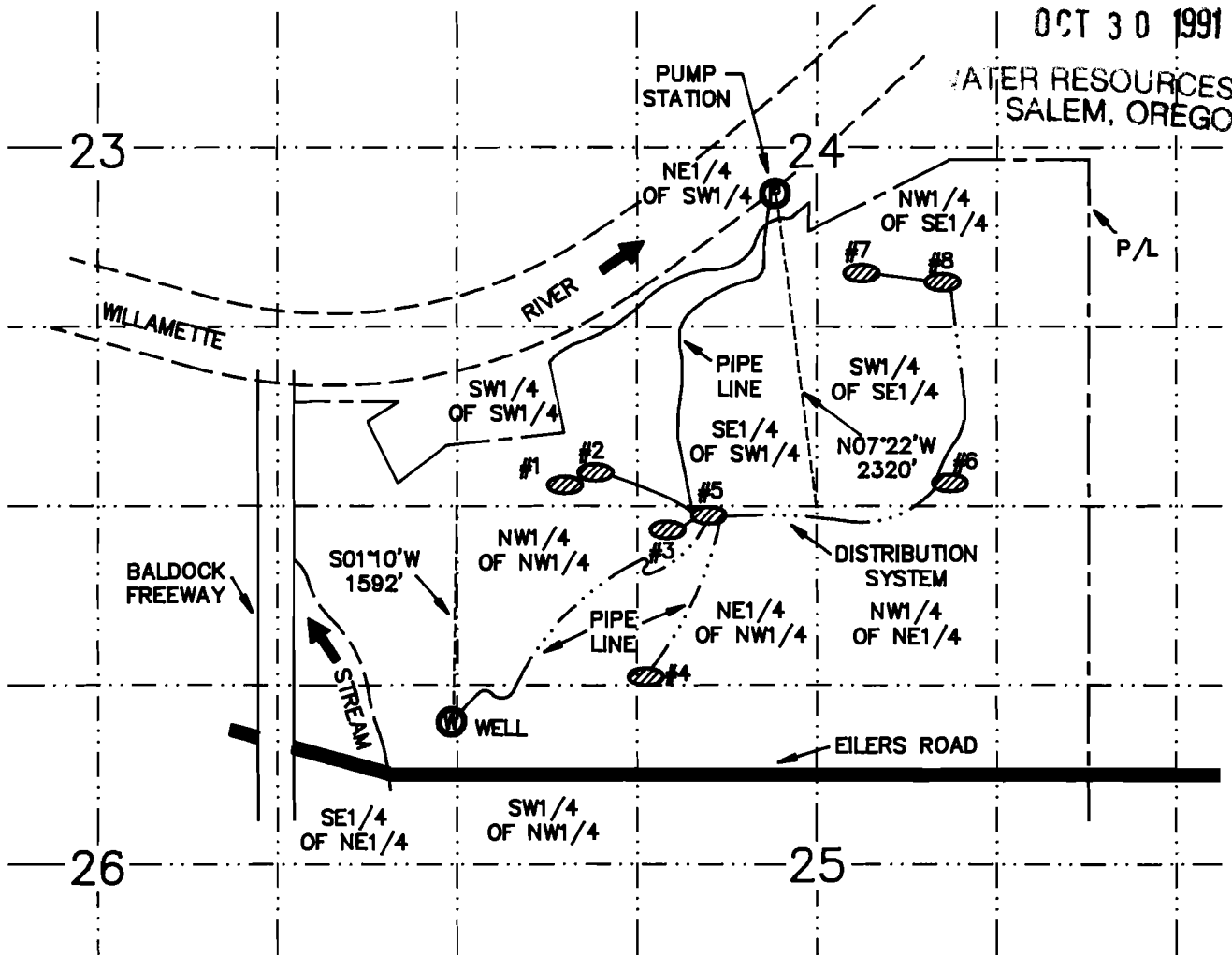

This drawing is an exhibit for a Final Proof Survey. It is not a Land Survey. Property lines and/or other lines of occupation shown hereon are not represented by the undersigned to meet accuracy standards of Land Surveys.



SCALE: 1" = 1320'
SECTIONS 24, 25, AND 26
T.3S., R.1W., W.M.
MARION COUNTY, OREGON

LEGEND

DENOTES POND/
RESERVOIR

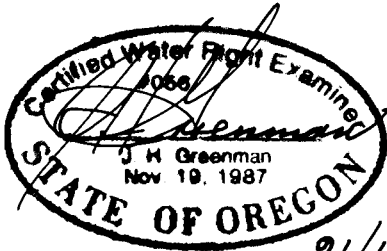

Application No.: R-69453
Permit No.: R-11131

HANER, ROSS & SPORSEEN, INC.
15 S.E. 82ND DR.
GLADSTONE, OREGON 97027

CHARBONNEAU GOLF CLUB, INC.
RESERVOIR
FINAL PROOF SURVEY